

**southco**  
 PROPRIETARY ITEM - EXCEPT FOR USES EXPRESSLY GRANTED IN WRITING INFORMATION DISCLOSED HEREON IS CONFIDENTIAL AND ALL RIGHTS PATENT AND OTHERWISE ARE RESERVED BY SOUTHCO, INC.

REV	DATE	DRAWN/CHKD	DESCRIPTION
A	03NOV2008	IR/DLH	RELEASED FOR PRODUCTION
B	09 DEC 08	IR/ACH	PRN: 2008-1345
C	04 FEB 09	IR/ACH	PRN: 2009-0162
D	22AUG2011	MJS/MSR	PRN: P2011-1073
E	22SEP2014	CMS/BGL	PRN: P2014-1872

DRAWING NUMBER	DRAWING CHKD	SCALE	DATE	MATERIAL	FINISH/COLOR
J-H3-60-301-0	IR	ACH	26 JUN 08	STEEL	ZINC PLATE
MILLIMETERS		DNS		STAINLESS	PASSIVATED

DESCRIPTION	MATERIAL	FINISH/COLOR	DESCRIPTION	MATERIAL	FINISH/COLOR
HANDLE	ZAMAC 3	BLACK POWDERCOAT	DISC COVER		
HOUSING			DUMMY CAM		
TOOL ACTUATOR			MIG - BRACKETS		
SHAFT			M4X0.7 SCREWS		
ROTATION LIMITER			CAM SCREW		
LOCKING PLUG			HANDLE PIN		
DIN LOCK ASSY			WAVE WASHER		
PANEL GASKET	SANTOPRENE		PADLOCK HASP		
HANDLE BUMPER	BUNA-N		RETAINER		
SHAFT O-RING					

**PART NUMBER: H3-60- A LL -0 FF**

**PADLOCK/SERIES:**  
 1, 2 = COVERED IN J-H3-60-101-0 OR J-H3-60-101-1  
 3 = NO PADLOCK, ACTUATOR  
 4 = PADLOCK, ACTUATOR

**LOCKING OPTIONS:**  
 00 = NO LOCK PROVIDED (DIN ONLY)  
 01 = CH751  
 02 = 300  
 03 = 333  
 04 = NON LOCKING  
 05 = HL450  
 20 = NON LOCKING DIN WITH DETENT  
 21 = DIN CH751  
 22 = DIN 300  
 23 = DIN 333  
 24 = DIN W/O LOCK PLUG  
 40 = TOOL, 3mm DOUBLE BIT  
 41 = TOOL, 5mm DOUBLE BIT  
 42 = TOOL, TELCORDIA 216 (BELLCOORE)  
 43 = TOOL, ELECTRONICS KEY  
 47 = TOOL, 8mm TRIANGLE  
 70 = DIN TOOL, 3mm DOUBLE BIT  
 71 = DIN TOOL, 5mm DOUBLE BIT  
 72 = DIN TOOL, TELCORDIA 216  
 73 = DIN TOOL, ELECTRONICS KEY  
 77 = DIN TOOL, 8mm TRIANGLE  
 OTHERS AVAILABLE UPON REQUEST

**ASSEMBLY FINISH:**  
 44 - SATIN CHROME  
 50 - BLACK POWDER COAT  
 OTHERS AVAILABLE UPON REQUEST

**GRIP TABLE**  
**CAM**  
**PART No. E5-61YY**

YY	GRIP	YY	GRIP
07	10.3	15	26.3
08	12.3	16	28.3
09	14.3	17	30.3
10	16.3	18	32.3
11	18.3	19	34.3
12	20.3	20	36.3
13	22.3	21	38.3
14	24.3	22	40.3

SEE J-E5-61-A

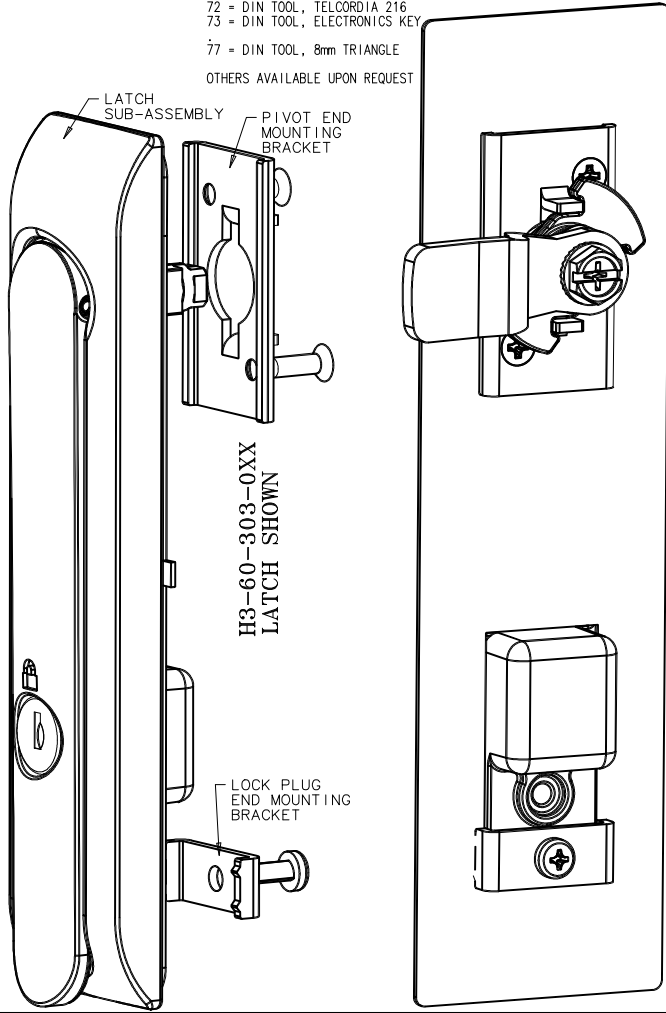

H3-60-303-0XX SHOWN AS A SINGLE POINT LATCH

SEE SHEET 2 FOR VIEWS OF DIN AND TOOL ACCESS VERSIONS

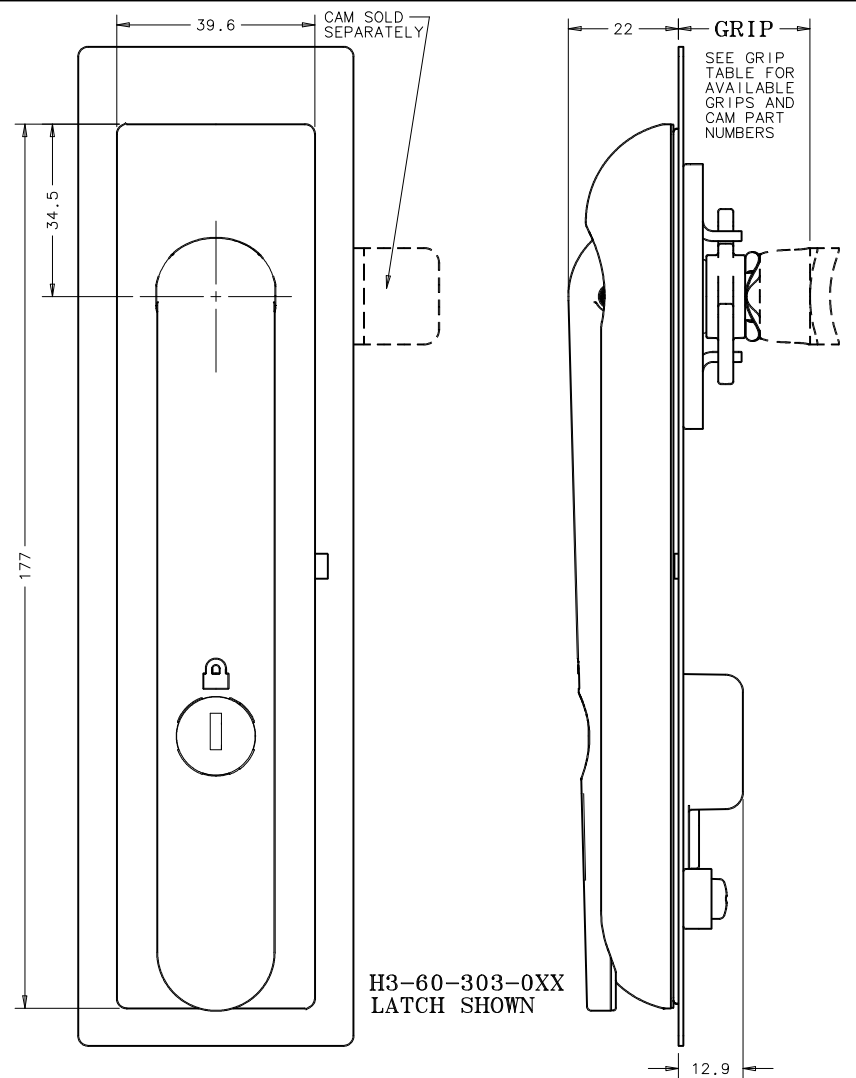

H3-60-303-0XX LATCH SHOWN

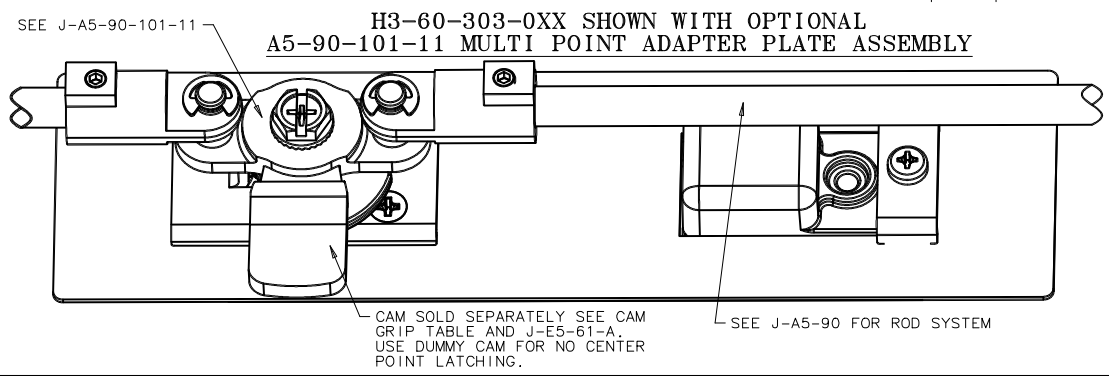

**southco**  
 PROPRIETARY ITEM - EXCEPT FOR USES EXPRESSLY GRANTED IN WRITING INFORMATION NOT DISCLOSED HEREON IS CONFIDENTIAL AND ALL RIGHTS RESERVED AND OTHERWISE ARE RESERVED BY SOUTHCO, INC.

DATE	DESCRIPTION	MATERIAL	FINISH/COLOR	DESCRIPTION	FINISH/COLOR
03NOV2008	IR/DLH RELEASED FOR PRODUCTION				
09 DEC 08	IR/ACH PRN: 2008-1345				
04 FEB 09	IR/ACH PRN: 2009-0162				
22AUG2011	MJS/MSR PRN: P2011-1073				
22SEP2014	CMS/BGL PRN: P2014-1872				

DATE	DESCRIPTION	MATERIAL	FINISH/COLOR
26 JUN 08	STEEL	STEEL	ZINC PLATE
	STAINLESS	STAINLESS	PASSIVATED

DRAWING NUMBER	DRAWING CHKD	SCALE
J-H3-60-301-0	IR	1:1

DESCRIPTION	MATERIAL	FINISH/COLOR
BLACK POWDERCOAT	ZAMAC 3	BLACK POWDERCOAT
NATURAL		NATURAL
CHROME PLATE		CHROME PLATE
NATURAL/BLACK		NATURAL/BLACK

DESCRIPTION	MATERIAL
DISC COVER	
DUMMY CAM	
MIG-BRACKETS	
M4x0.7 SCREWS	
CAM SCREW	
HANDLE PIN	
WAVE WASHER	
PADLOCK HASP	
RETAINER	

DESCRIPTION	MATERIAL
HANDLE	
HOUSING	
TOOL ACTUATOR	
SHAFT	
ROTATION LIMITER	
LOCKING PANEL	
LOCK PLUG	
DIN LOCK ASSY	
PANEL CASKET	SANTOPRENE
HANDLE BUMPER	BUNA-N
SHAFT O-RING	

**PANEL PREPARATION**

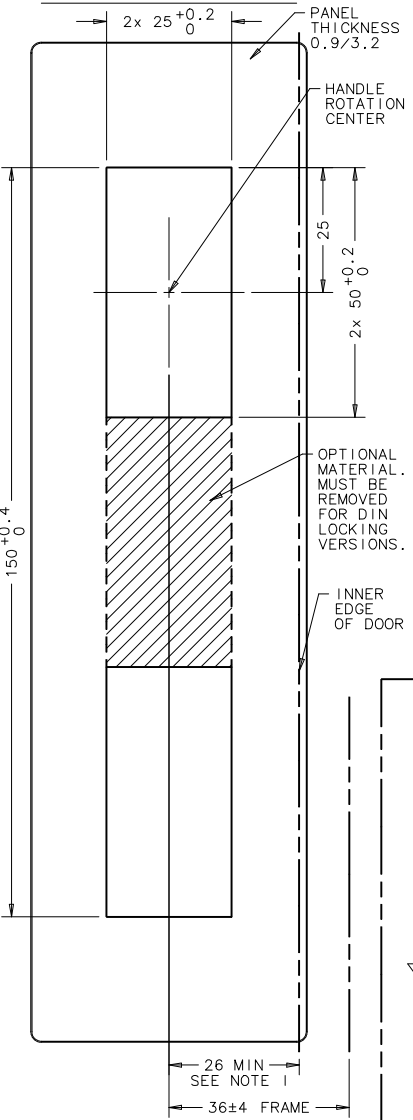

**NOTES:**

- ALL LATCH COMPONENTS ARE RoHS COMPLIANT.
- LATCH INSTALLATION:
  - PREPARE A BURR FREE PANEL OPENING AS SHOWN.
  - INSTALL LATCH SUB-ASSEMBLY FROM THE FRONT SIDE OF THE PANEL AND HOLD IN PLACE.
  - FROM THE BACK SIDE OF THE PANEL, SLIDE THE PIVOT END MOUNTING BRACKET ONTO THE HANDLE SHAFT.
  - SECURE THE PIVOT END MOUNTING BRACKET IN PLACE WITH THE TWO FLAT HEAD M4x0.7x12 SCREWS PROVIDED. ATTACH THE LOCK PLUG END MOUNTING BRACKET TO THE HOUSING AS SHOWN AND SECURE IN PLACE WITH PAN HEAD M4x0.7x12 SCREW. MAX MOUNTING BRACKET SCREW TORQUE 1.5 N-m.
  - PLACE THE ROTATION LIMITER ONTO THE HANDLE SHAFT. THE ROTATION LIMITER ALSO SETS THE ROTATION ACTUATION DIRECTION OF THE LATCH. TO FLIP ACTUATION DIRECTION, SIMPLY REMOVE THE ROTATION LIMITER FROM THE SHAFT, ROTATE IT 90°, AND PLACE BACK ONTO SHAFT.
  - PLACE SHAFT WAVE WASHER ONTO HANDLE SHAFT AGAINST THE TOP OF THE ROTATION LIMITER, FOLLOWED BY THE CAM, THEN THE ACTUATOR PLATE ASSEMBLY IF USED. SECURE EVERYTHING TO THE SHAFT USING M6x1x14 SCREW. MAX SCREW TORQUE 2.0 N-m.
  - CYCLE THE LATCH FROM OPEN TO CLOSE TO MAKE SURE EVERYTHING MOVES FREELY.
  - FOR TWO POINT LATCHING (NO CENTER LATCHING), A "DUMMY CAM" MUST BE USED TO MAINTAIN PROPER ASSEMBLY SPACING.
  - IF USED WITH SOUTHCO A5-90-101-11 ADAPTER PLATE ASSEMBLY.
- COSMETIC SPECIFICATION: ALL POWDERCOATED OR CHROME PLATED SURFACES, UNLESS OTHERWISE NOTED, ARE TO CONFORM TO A CLASS "B" DESIGNATION. ALL OTHER SURFACES, UNLESS OTHERWISE NOTED, ARE TO CONFORM TO A CLASS "C" DESIGNATION AS DESCRIBED IN SOUTHCO COSMETIC SPECIFICATIONS:
  - S-121-02 FOR CHROME PLATING
  - S-121-02 FOR ZINC PLATING
  - S-121-03 FOR POWDER COATING
  - S-121-05 FOR STAINLESS STEEL PARTS

**HARDWARE PACK**

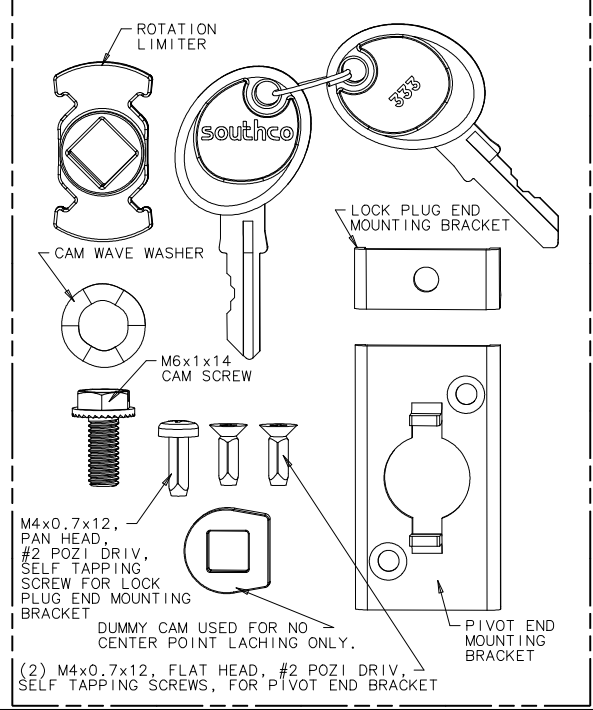

**PROPER CAM & LIMITER INSTALLATION FOR ROTATING HANDLE CCW TO OPEN**

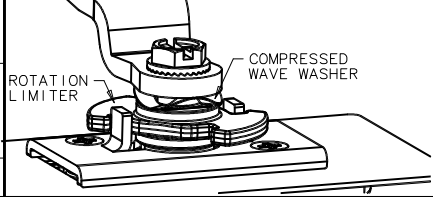

**PROPER CAM, A5 ACTUATOR PLATE, & LIMITER INSTALLATION FOR ROTATING HANDLE CCW TO OPEN**

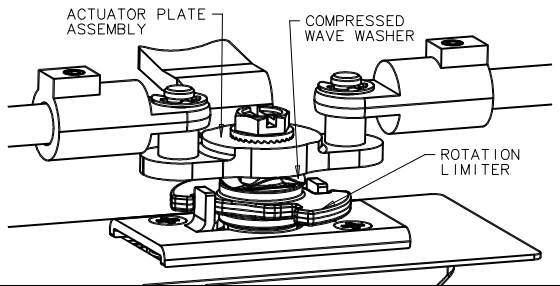

**H3-60-323-OXX  
333 DIN**

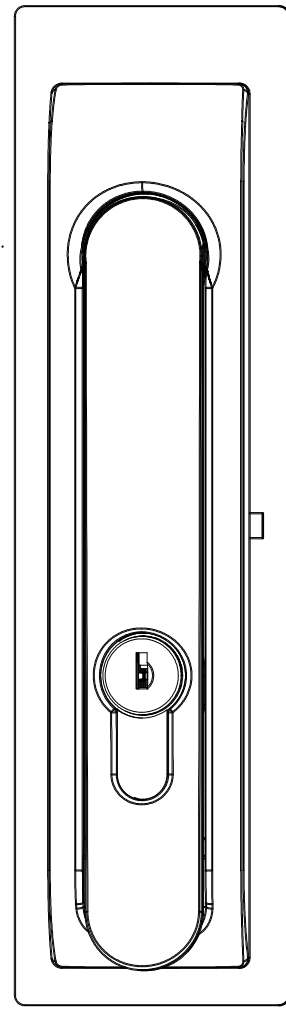

**H3-60-342-OXX  
BELLCORE/TELCORDIA 216**

