

# Bellows suction cup (round)

<https://www.schmalz.com/10.01.06.03146>



FSGPL 200 HT1-60 G1/2-IG

Part no.: 10.01.06.03146

Homepage > Vacuum Technology for Automation > Vacuum Components > Vacuum Suction Cups > Bellows Suction Cups (Round) > Bellows Suction Cups FSGPL (1.5 Folds) > FSGPL 200 HT1-60 G1/2-IG

## Bellows suction cup (round) for large, heavy and uneven workpieces



Size: 200  
Suction cup material:  
High temp material HT1  
Material hardness: 60 °Sh  
Vacuum connection: G1/2-F  
Nipple material: Steel  
Number of folds: 1.5

### Design Data

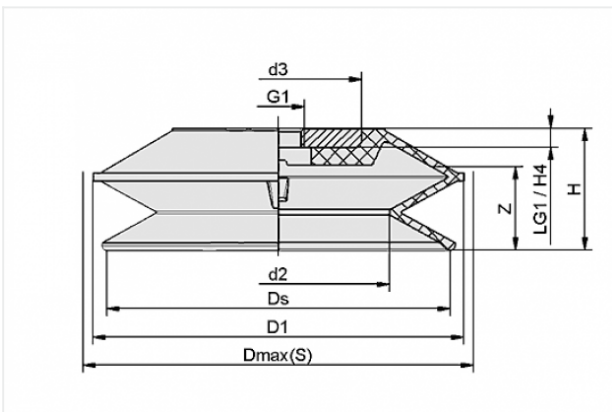

Attribute	Value
-----------	-------

d2	137 mm
d3	119.4 mm
D1	202 mm
Dmax(S)	208 mm
Ds	191 mm
G1	G1/2"-F
H	54 mm
H4	8 mm
LG1	8 mm
Z	37.2 mm

### Contact to Schmalz

J. Schmalz GmbH | Johannes-Schmalz-Straße, 72293 Glatten, Deutschland | +49 7443 2403-102 | [customercenter@schmalz.de](mailto:customercenter@schmalz.de)

## Technical Data

Attribute	Value
Suction force	850 N
Pull-off force	950 N
Volume	876.516 cm <sup>3</sup>
Curve radius (min) (convex)	350 mm
Internal hose diameter (recom.)	12 mm
Size	200
Suction cup material	High temp material HT1
Material hardness	60 °Sh
Weight	1,014.5 g
Number of folds	1.5
Product family	FSGPL

### Note:

- Suction force: The specified suction forces are theoretical values at a vacuum of -0.6 bar and with a smooth, dry workpiece surface - they do not include a safety factor
- Hose diameter: The recommended hose diameter refers to a hose length of approx. 2 m