

# Bellows suction cup (round)

<https://www.schmalz.com/10.01.06.03151>



## FSGPL 120 HT1-60 G1/2-IG

Part no.: 10.01.06.03151

Homepage > Vacuum Technology for Automation > Vacuum Components > Vacuum Suction Cups > Bellows Suction Cups (Round) > Bellows Suction Cups FSGPL (1.5 Folds) > FSGPL 120 HT1-60 G1/2-IG

### Bellows suction cup (round) for large, heavy and uneven workpieces



Size: 120  
Suction cup material:  
High temp material HT1  
Material hardness: 60 °Sh  
Vacuum connection: G1/2-F  
Nipple material: Steel  
Number of folds: 1.5

#### Design Data

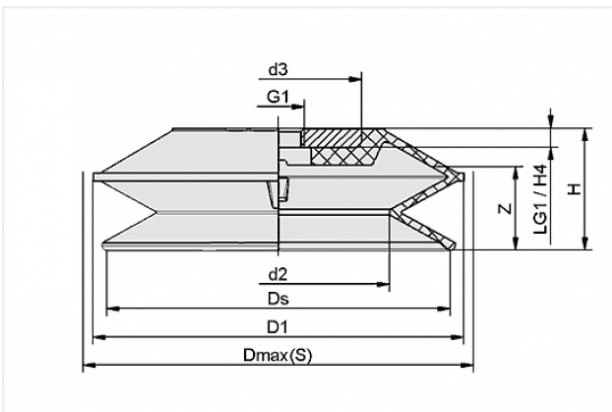

Attribute	Value
-----------	-------

d2	79.3 mm
----	---------

d3	69.4 mm
----	---------

D1	127.8 mm
----	----------

Dmax(S)	135 mm
---------	--------

Ds	118.2 mm
----	----------

G1	G1/2"-F
----	---------

H	51 mm
---	-------

H4	8 mm
----	------

LG1	8 mm
-----	------

Z	35.7 mm
---	---------

#### Contact to Schmalz

J. Schmalz GmbH | Johannes-Schmalz-Straße, 72293 Glatten, Deutschland | +49 7443 2403-102 | [customercenter@schmalz.de](mailto:customercenter@schmalz.de)

## Technical Data

Attribute	Value
Suction force	280 N
Volume	295.203 cm <sup>3</sup>
Curve radius (min) (convex)	150 mm
Internal hose diameter (recom.)	12 mm
Size	120
Suction cup material	High temp material HT1
Material hardness	60 °Sh
Weight	332 g
Number of folds	1.5
Product family	FSGPL

### Note:

- Suction force: The specified suction forces are theoretical values at a vacuum of -0.6 bar and with a smooth, dry workpiece surface - they do not include a safety factor
  - Hose diameter: The recommended hose diameter refers to a hose length of approx. 2 m
- 
-