

Bellows suction cup (round)

<https://www.schmalz.com/10.01.06.03150>



FSGPL 100 HT1-60 G1/2-IG

Part no.: 10.01.06.03150

Homepage > Vacuum Technology for Automation > Vacuum Components > Vacuum Suction Cups > Bellows Suction Cups (Round) > Bellows Suction Cups FSGPL (1.5 Folds) > FSGPL 100 HT1-60 G1/2-IG

Bellows suction cup (round) for large, heavy and uneven workpieces



Size: 100
Suction cup material:
High temp material HT1
Material hardness: 60 °Sh
Vacuum connection: G1/2-F
Nipple material: Steel
Number of folds: 1.5

Design Data

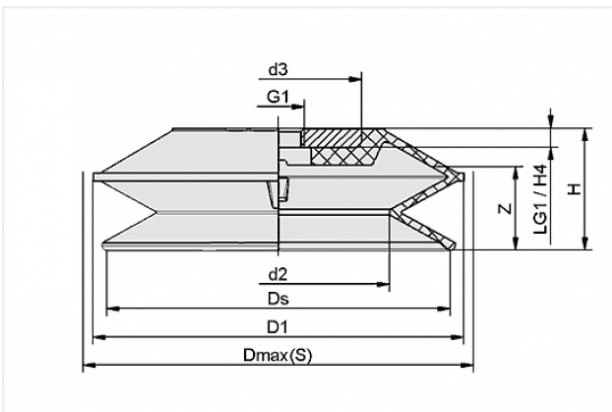

Attribute	Value
-----------	-------

d2	57.2 mm
----	---------

d3	44 mm
----	-------

D1	101 mm
----	--------

Dmax(S)	106.5 mm
---------	----------

Ds	96.1 mm
----	---------

G1	G1/2"-F
----	---------

H	43.3 mm
---	---------

H4	8 mm
----	------

LG1	8 mm
-----	------

Z	29.1 mm
---	---------

Contact to Schmalz

J. Schmalz GmbH | Johannes-Schmalz-Straße, 72293 Glatten, Deutschland | +49 7443 2403-102 | customercenter@schmalz.de

Technical Data

Attribute	Value
Suction force	150 N
Volume	150 cm ³
Curve radius (min) (convex)	100 mm
Internal hose diameter (recom.)	12 mm
Size	100
Suction cup material	High temp material HT1
Material hardness	60 °Sh
Weight	145 g
Number of folds	1.5
Product family	FSGPL

Note:

- Suction force: The specified suction forces are theoretical values at a vacuum of -0.6 bar and with a smooth, dry workpiece surface - they do not include a safety factor
 - Hose diameter: The recommended hose diameter refers to a hose length of approx. 2 m
-
-