

# Flow resistance

## SW 110 G1/4-AG

Part no.: 10.05.04.00017

<https://www.schmalz.com/10.05.04.00017>



Homepage > Vacuum Technology for Automation > Vacuum Components > Valve Technology > Check Valves and Flow Restrictors > Flow Restrictors SW > SW 110 G1/4-AG

### Flow resistor for reduction of the volume flow rate



Nominal size: 1.10 mm  
Length L: 6 mm  
Thread G1: G1/4-M  
Material: Aluminium

### Design Data

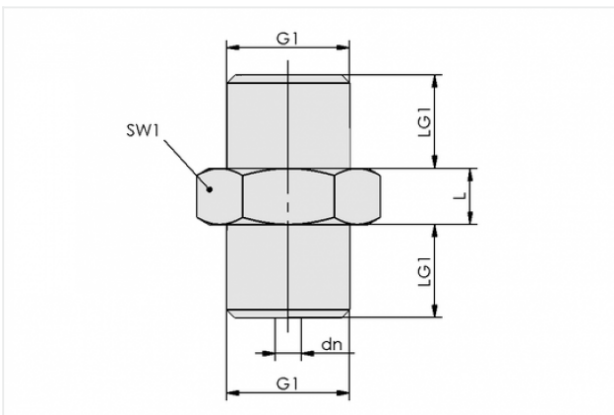

Attribute	Value
G1	G1/4"-M
dn	1.1 mm
L	6 mm
LG1	10 mm
SW1	17 mm

### Technical Data

Attribute	Value
Nominal size	1.10 mm
Evacuation rate for $p_u = -0,3$ bar	0.62 m <sup>3</sup> /h

### Contact to Schmalz

J. Schmalz GmbH | Johannes-Schmalz-Straße, 72293 Glatten, Deutschland | +49 7443 2403-102 | [customercenter@schmalz.de](mailto:customercenter@schmalz.de)



<b>Attribute</b>	<b>Value</b>
Evacuation rate for pu = -0,3 bar	10.3 l/min
Evacuation rate for pu = -0,6 bar	0.63 m <sup>3</sup> /h
Evacuation rate for pu = -0,6 bar	10.5 l/min
Weight	9.5 g

---

---