

# Check valve

## SVK G1/2-IG

Part no.: 10.05.03.00037

<https://www.schmalz.com/10.05.03.00037>



Homepage > Vacuum Technology for Automation > Vacuum Components > Valve Technology > Check Valves and Flow Restrictors > Check Valves  
SVK, SVKG, SVV > SVK G1/2-IG

### Check valve for deactivation of unused suction pads



Thread 1: G1/2-M

Thread 2: G1/2-F

### Design Data

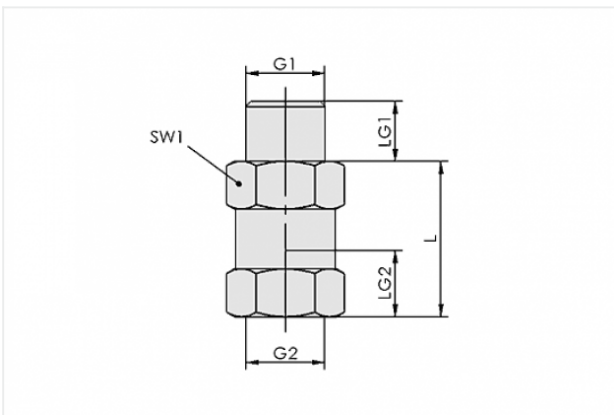

Attribute	Value
-----------	-------

G1	G1/2"-M
----	---------

G2	G1/2"-F
----	---------

L	29 mm
---	-------

LG1	12 mm
-----	-------

LG2	14 mm
-----	-------

SW1	27 mm
-----	-------

### Technical Data

Attribute	Value
-----------	-------

Evacuation rate for $p_u = -0,3$ bar	0.49 m <sup>3</sup> /h
--------------------------------------	------------------------

Evacuation rate for $p_u = -0,3$ bar	8.1 l/min
--------------------------------------	-----------

### Contact to Schmalz

J. Schmalz GmbH | Johannes-Schmalz-Straße, 72293 Glatten, Deutschland | +49 7443 2403-102 | [customercenter@schmalz.de](mailto:customercenter@schmalz.de)



Attribute	Value
Evacuation rate for $p_u = -0,6$ bar	0.54 m <sup>3</sup> /h
Evacuation rate for $p_u = -0,6$ bar	9 l/min
Flow rate (max)	47.4 m <sup>3</sup> /h
Flow rate (max)	790 l/min
Weight	47.4 g