

Solenoid valve

EMVP 5 24V-DC 3/2 NC

<https://www.schmalz.com/10.05.02.00162>



Part no.: 10.05.02.00162

Homepage > Vacuum Technology for Automation > Vacuum Components > Valve Technology > Solenoid Valves > Solenoid Valves EMVP > EMVP 5 24V-DC 3/2 NC

Solenoid valve EMVP for vacuum, pneumatic pilot control



Nominal size: 5 mm
 Voltage: 24V - DC
 Function: 3/2-way valve
 Control: Normally closed
 Connecting thread: G1/8"-F
 Pressure range (operating pressure):
 -0.95 ... 8.00 bar
 Control pressure range:
 3.0 ... 6.0 bar
 Nominal flow rate: 3 m³/h
 Weight: 0.11 kg

Design Data

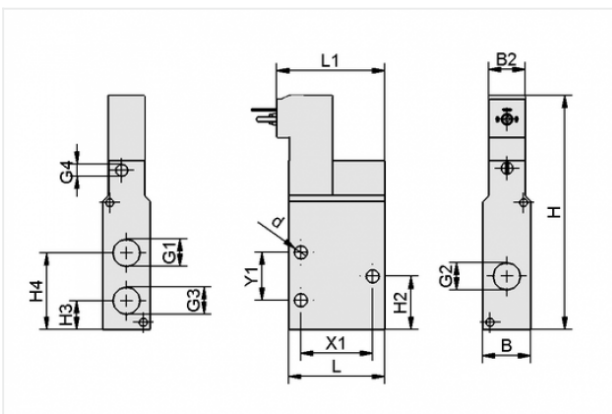

Attribute	Value
B	15 mm
B2	15 mm
d	4.3 mm
G1	G1/8"-F
G2	G1/8"-F
G3	G1/8"-F
G4	M5-F
H	88.4 mm
H2	19.5 mm
H3	12 mm
H4	27 mm

Contact to Schmalz

J. Schmalz GmbH | Johannes-Schmalz-Straße, 72293 Glatten, Deutschland | +49 7443 2403-102 | customercenter@schmalz.de

Attribute	Value
L	32 mm
L1	37 mm
X1	23 mm
Y1	15 mm

Technical Data

Attribute	Value
Nominal size	5 mm
Control	Normally closed
Nominal flow rate	50 l/min
Nominal flow rate	3 m ³ /h
Power consumption (DC)	1 W
Voltage	24V - DC
Closing time	19 ms
Weight	0.11 kg
