

Vacuum unit (pneumatic) VE 15

<https://www.schmalz.com/10.02.03.00325>



Part no.: 10.02.03.00325

Homepage > Vacuum Technology for Automation > Vacuum Components > Vacuum Generators > Vacuum Units > Vacuum Units VE / VER > VE

15

Pneumatic vacuum generator with manometer and non-return valve



Nozzle size: 1,5 mm
Vacuum (max): -800 mbar
Suction rate (max): 4.1 m³/h
Air consumption: 6.1 m³/h

Design Data

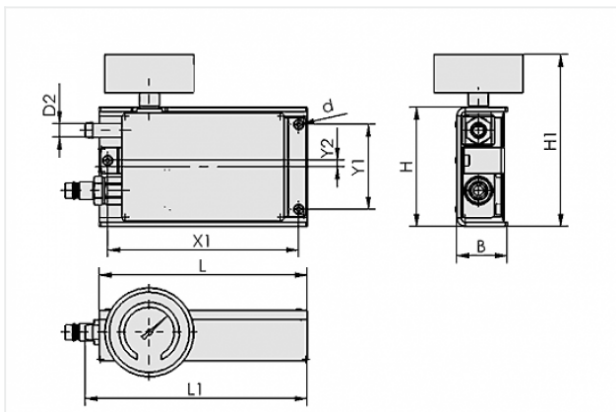

Attribute	Value
-----------	-------

B	35 mm
---	-------

d	4.2 mm
---	--------

D2	9.5 mm
----	--------

H	83 mm
---	-------

H1	120 mm
----	--------

L	145 mm
---	--------

L1	154.5 mm
----	----------

X1	133 mm
----	--------

Y1	59 mm
----	-------

Y2	4.5 mm
----	--------

Contact to Schmalz

J. Schmalz GmbH | Johannes-Schmalz-Straße, 72293 Glatten, Deutschland | +49 7443 2403-102 | customercenter@schmalz.de

Technical Data

Attribute	Value
Nozzle diameter	1.5 mm
Degree of evacuation	80 %
Suction rate (max)	69 l/min
Suction rate (max)	4.1 m ³ /h
Air consumption	102 l/min
Air consumption	6.1 m ³ /h
Weight	1.4 kg

Note:

- Air consumption: At optimal operating pressure

Accessories



DM 0.5...10 KUPP

Part no. 13.02.01.10171

Pressure-reduction valve

Work area: 0.5 ... 10.0 bar

Connection: Plug-in nipp/coupler
with: Manometer

Flow rate (max): 40 m³/h

Secondary venting: 25 bar
for: Work benches/stands