

# Vacuum pump

## EVE-TR 250 AC3/S001 F IE2

<https://www.schmalz.com/10.03.01.00267>



Part no.: 10.03.01.00267

Homepage > Vacuum Technology for Automation > Vacuum Components > Vacuum Generators > Vacuum Pumps > Dry-Running Vacuum Pumps  
EVE-TR > EVE-TR 250 AC3/S001 F IE2

### Oil-free pump with constant suction rate, robust, requires little maintenance



Current type: 3-phase AC  
 Noise level (50 Hz): 77 dB  
 Voltage (50 Hz): 400V ±10%  
 Voltage (60 Hz): D460V ±10%  
 Voltage (60 Hz-opt): 400V ±10%  
 with: Filter  
 Suction rate (50 Hz): 244 m³/h  
 Suction rate (60 Hz): 286 m³/h  
 Vacuum (50Hz): -800 mbar  
 Permission: IE2  
 Rated power (50 Hz): 5.5 kW  
 Rated power (60 Hz): 6.6 kW  
 Weight: 222 kg

### Design Data

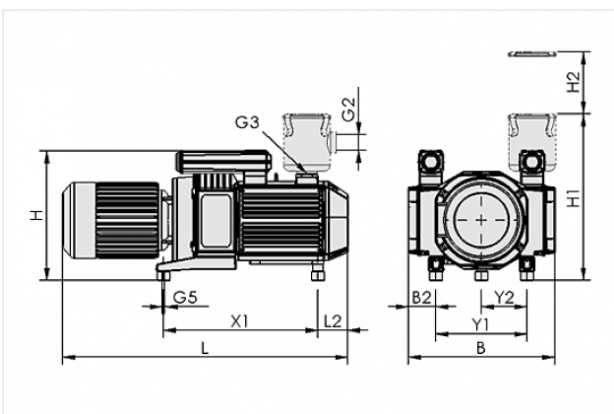

Attribute	Value
B	644 mm
B2	116 mm
G3	G2-1/2"-F
G5	M10-F
H	530 mm
L	1059 mm
L2	123.8 mm
X1	645 mm
Y1	380 mm
Y2	190 mm

### Contact to Schmalz

J. Schmalz GmbH | Johannes-Schmalz-Straße, 72293 Glatten, Deutschland | +49 7443 2403-102 | [customercenter@schmalz.de](mailto:customercenter@schmalz.de)

## Technical Data

Attribute	Value
Suction rate (50 Hz)	244 m <sup>3</sup> /h
Suction rate (60 Hz)	286 m <sup>3</sup> /h
Voltage (50 Hz)	400V ±10%
Voltage (60 Hz)	D460V ±10%
Rated power (50 Hz)	5.5 kW
Rated power (60 Hz)	6.6 kW
Current type	AC3
Noise level (50 Hz)	77 dB
Weight	222 kg
Protection	IP 55

## Spare Parts

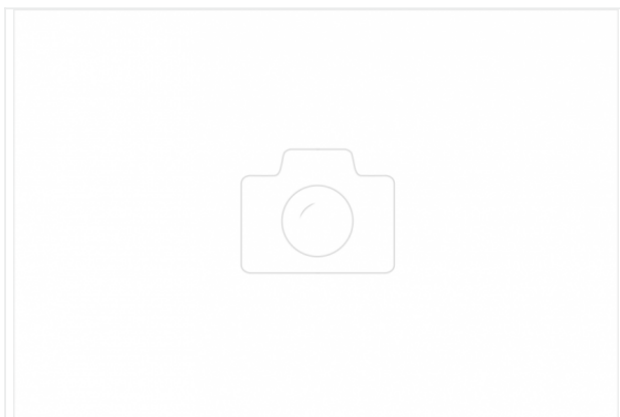

### VST EVE-TR-250

Part no. 10.03.01.00299

Set of parts subject to wear pump

for: Pump EVE-TR

Size: 250

contains: Brush slide/Filter