

Compact ejector

SMP 20 NC AS VD

<https://www.schmalz.com/10.02.02.00578>



Part no.: 10.02.02.00578

Homepage > Vacuum Technology for Automation > Vacuum Components > Vacuum Generators > Compact Ejectors > Compact Ejectors SCP /

SMP > SMP 20 NC AS VD

Compact ejector MEGA PUMP with power blow-off function



Nozzle size: 2,0 mm
 Suction rate (max): 116 l/min
 Air consumption (during evac.):
 190 l/min
 Control: Normally closed
 Shape: With blow-off system
 with: digital vacuum switch

Design Data

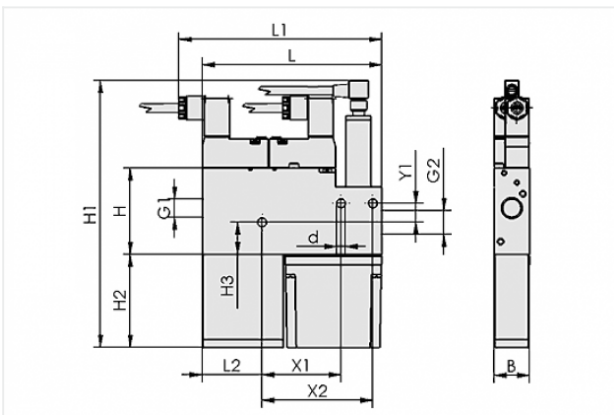

| Attribute | Value |
|-----------|----------|
| B | 22 mm |
| d | 5.5 mm |
| G1 | G1/4"-F |
| G2 | G3/8"-F |
| H | 54 mm |
| H1 | 181.5 mm |
| H2 | 58.5 mm |
| H3 | 20.1 mm |
| L | 112.5 mm |
| L1 | 129 mm |
| L2 | 37.5 mm |
| X1 | 49.5 mm |
| X2 | 69.5 mm |

Contact to Schmalz

J. Schmalz GmbH | Johannes-Schmalz-Straße, 72293 Glatten, Deutschland | +49 7443 2403-102 | customercenter@schmalz.de

| Attribute | Value |
|-----------|-------|
| Y1 | 12 mm |

Technical Data

| Attribute | Value |
|---|------------------------|
| Nozzle diameter | 2 mm |
| Degree of evacuation | 85 % |
| Suction rate (max) | 116 l/min |
| Suction rate (max) | 7 m ³ /h |
| Air consumption (during evac.) | 190 l/min |
| Air consumption (during evac.) | 11.4 m ³ /h |
| Air consumption (blow off) (max) | 220 l/min |
| Noise level (workp. gripped) | 76 dB |
| Noise level (free) | 78 dB |
| Pressure range (operating pressure) | 5.0 ... 6.0 bar |
| Int. hose diameter (recom.) comp.-air | 4 mm |
| Int. hose diameter (recom.) vacuum side | 9 mm |
| Ambient temperature | 0 ... 45 °C |
| Control | Normally closed |
| Pressure range (operating pressure) | 72.5 ... 87.0 psi |
| Suction rate (max) | 4.096 cfm |
| Air consumption (during evac.) | 6.709 cfm |
| Air consumption (blow off) | 7.769 cfm |
| Product family | SMP |

Note:

- The supply voltage for vacuum switches and solenoid valves is 24V DC
- Air consumption: At optimal operating pressure

Contact to Schmalz

- Hose diameter: For max. length 2 m

Spare Parts



SD 50.5x21x53.5 SMP15/20

Part no. 10.02.02.00651

Silencer for vacuum generators

Length L: 50.5 mm

Width B: 21 mm

Height H: 53.5 mm

for: Compact ejectors SMP



FILT-EINS 14x49 PE-POR SCP-SMP

Part no. 10.02.02.00654

Filter insert (round)

External diameter D: 14 mm

Length L: 49 mm

Filter material: Polyethylene

for: Compact ejectors

Accessories

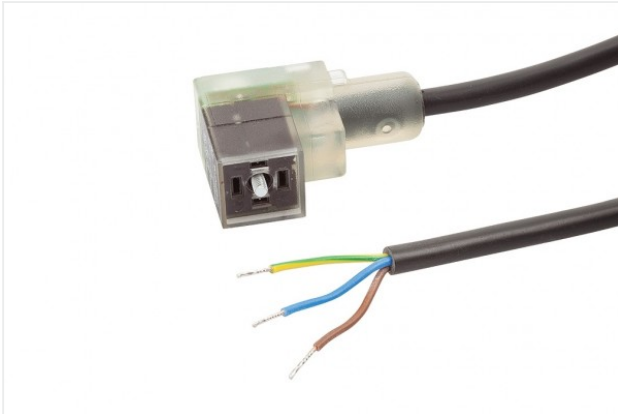

ASK B-Form-C 5000 K-3P

Part no. 21.04.06.00084

Connection cable

Interface Connection 1:

Fem connect Form C

Cable length: 5000 mm

Interface Connection 2: Cable 3

Material: PVC-Cable

Shape: LED display

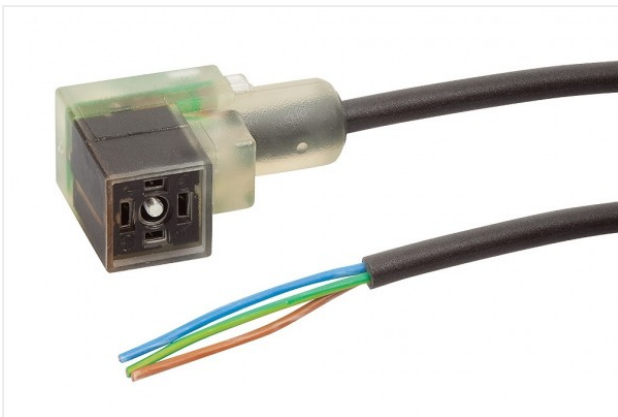

ASK 10000 K-3P

Part no. 21.04.06.00118

Connection cable

Cable length: 10000 mm

Interface Connection 2: Cable 3

Material: PUR-Cable

Shape: LED display



ASS B-C SK

Part no. 21.04.06.00085

Connection plug

Interface Connection 1:

Socket DIN 175301-803A

Electrical connection: Screw contact



ASK B-M8-4 5000 K-4P

Part no. 10.06.02.00031

Connection cable

Interface Connection cable:

Fem connect M8, 4 pol

Cable length: 5000 mm

Interface Connection cable: Cable 4

Material: PUR-Cable



ASK WB-M8-4 5000 K-4P

Part no. 10.06.02.00032

Connection cable

Interface Connection cable:

Elbow fem con M8, 4 pol

Cable length: 5000 mm

Interface Connection cable: Cable 4

Material: PUR-Cable