

Hose sleeve

ST G1-AG 32 MS-V

Part no.: 10.08.03.00168

<https://www.schmalz.com/10.08.03.00168>



Homepage > Vacuum Technology for Automation > Vacuum Components > Filters and Connections > Hoses and Connectors > Accessories for Screw Unions > ST G1-AG 32 MS-V

Hose sleeve



Thread 1: G1-M
Internal hose diameter: 32 mm
Material: Brass
Surface: nickel plated

Design Data

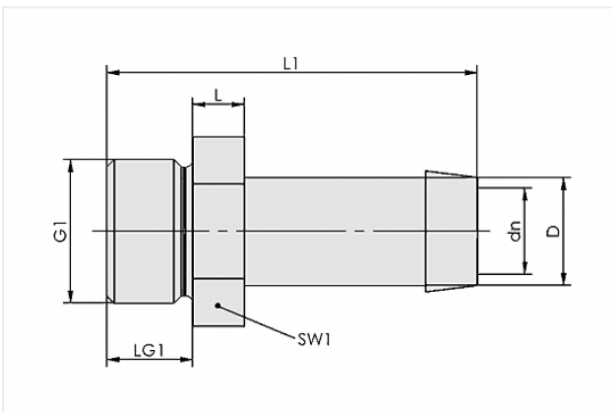

Attribute	Value
-----------	-------

dn	26 mm
----	-------

D	32 mm
---	-------

G1	G1"-M
----	-------

L	10.5 mm
---	---------

L1	62 mm
----	-------

LG1	16 mm
-----	-------

SW1	36 mm
-----	-------

Technical Data

Attribute	Value
-----------	-------

Material	Brass
----------	-------

Contact to Schmalz

J. Schmalz GmbH | Johannes-Schmalz-Straße, 72293 Glatten, Deutschland | +49 7443 2403-102 | customercenter@schmalz.de

Attribute	Value
Weight	176 g

Accessories



VSL 41-32 PVC-DS

Part no. 10.07.09.00008

Hose for vacuum and compressed-air systems

External diameter D: 41 mm

Internal diameter d: 32 mm

Length (max): 30 m

Material: PVC, with wire spiral

Installation radius (min): 110 mm

Pressure range (operating pressure):

-0.85 ... 4.00 bar

Ambient temperature: -20 ... 70 °C
