

Hose sleeve

ST G1/2-AG 9 MS-V

Part no.: 10.08.03.00161

<https://www.schmalz.com/10.08.03.00161>



Homepage > Vacuum Technology for Automation > Vacuum Components > Filters and Connections > Hoses and Connectors > Accessories for Screw Unions > ST G1/2-AG 9 MS-V

Hose sleeve



Thread 1: G1/2-M
Internal hose diameter: 9 mm
Material: Brass
Surface: nickel plated

Design Data

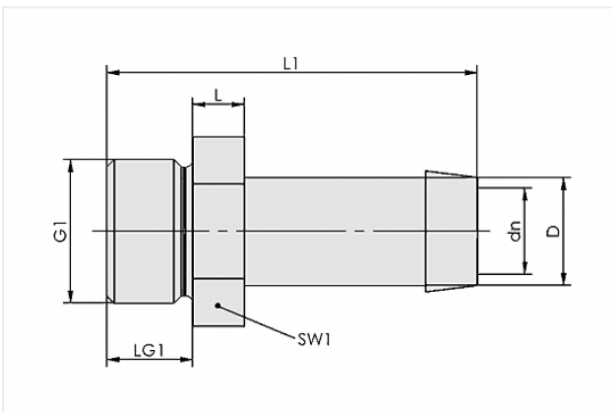

Attribute	Value
dn	7.5 mm
D	8.6 mm
G1	G1/2"-M
L	6.1 mm
L1	45 mm
LG1	11.9 mm
SW1	24 mm

Technical Data

Attribute	Value
Material	Brass

Contact to Schmalz

J. Schmalz GmbH | Johannes-Schmalz-Straße, 72293 Glatten, Deutschland | +49 7443 2403-102 | customercenter@schmalz.de

Attribute	Value
Weight	50 g

Accessories



VSL 12-9 PE

Part no. 10.07.09.00050
 Hose for vacuum and compressed-air systems
 External diameter D: 12 mm
 Internal diameter d: 9 mm
 Length (max): 100 m
 Material: PE
 Installation radius (min): 70 mm
 Pressure range (operating pressure):
 -0.95 ... 10.00 bar
 Ambient temperature: -20 ... 70 °C



VSL 12-9 PU

Part no. 10.07.09.00037
 Hose for vacuum and compressed-air systems
 External diameter D: 12 mm
 Internal diameter d: 9 mm
 Length (max): 50 m
 Material: PU
 Installation radius (min): 70 mm
 Pressure range (operating pressure):
 -0.95 ... 10.00 bar
 Ambient temperature: -20 ... 90 °C



VSL 15-9 PVC-G

Part no. 10.07.09.00005
 Hose for vacuum and compressed-air systems
 External diameter D: 15 mm
 Internal diameter d: 9 mm
 Length (max): 50 m
 Material: PVC, with textile layer
 Installation radius (min): 50 mm
 Pressure range (operating pressure):
 -0.95 ... 10.00 bar
 Ambient temperature: -20 ... 70 °C

