

Hose sleeve

ST G3/8-AG 9 MS-V

Part no.: 10.08.03.00159

<https://www.schmalz.com/10.08.03.00159>



Homepage > Vacuum Technology for Automation > Vacuum Components > Filters and Connections > Hoses and Connectors > Accessories for Screw Unions > ST G3/8-AG 9 MS-V

Hose sleeve



Thread 1: G3/8-M
Internal hose diameter: 9 mm
Material: Brass
Surface: nickel plated

Design Data

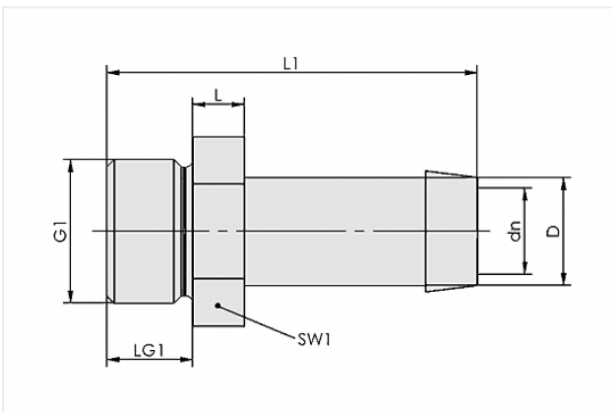

Attribute	Value
-----------	-------

dn	7.4 mm
----	--------

D	8.5 mm
---	--------

G1	G3/8"-M
----	---------

L	6 mm
---	------

L1	43 mm
----	-------

LG1	10 mm
-----	-------

SW1	19 mm
-----	-------

Technical Data

Attribute	Value
-----------	-------

Material	Brass
----------	-------

Contact to Schmalz

J. Schmalz GmbH | Johannes-Schmalz-Straße, 72293 Glatten, Deutschland | +49 7443 2403-102 | customercenter@schmalz.de

Attribute	Value
Weight	31 g

Accessories



VSL 12-9 PE

Part no. 10.07.09.00050
Hose for vacuum and compressed-air systems
External diameter D: 12 mm
Internal diameter d: 9 mm
Length (max): 100 m
Material: PE
Installation radius (min): 70 mm
Pressure range (operating pressure):
-0.95 ... 10.00 bar
Ambient temperature: -20 ... 70 °C



VSL 12-9 PU

Part no. 10.07.09.00037
Hose for vacuum and compressed-air systems
External diameter D: 12 mm
Internal diameter d: 9 mm
Length (max): 50 m
Material: PU
Installation radius (min): 70 mm
Pressure range (operating pressure):
-0.95 ... 10.00 bar
Ambient temperature: -20 ... 90 °C



VSL 15-9 PVC-G

Part no. 10.07.09.00005
Hose for vacuum and compressed-air systems
External diameter D: 15 mm
Internal diameter d: 9 mm
Length (max): 50 m
Material: PVC, with textile layer
Installation radius (min): 50 mm
Pressure range (operating pressure):
-0.95 ... 10.00 bar
Ambient temperature: -20 ... 70 °C

