

# Hose sleeve

## ST G1/4-AG 9 MS-V

Part no.: 10.08.03.00157

<https://www.schmalz.com/10.08.03.00157>



Homepage > Vacuum Technology for Automation > Vacuum Components > Filters and Connections > Hoses and Connectors > Accessories for Screw Unions > ST G1/4-AG 9 MS-V

## Hose sleeve



Thread 1: G1/4-M  
Internal hose diameter: 9 mm  
Material: Brass  
Surface: nickel plated

## Design Data

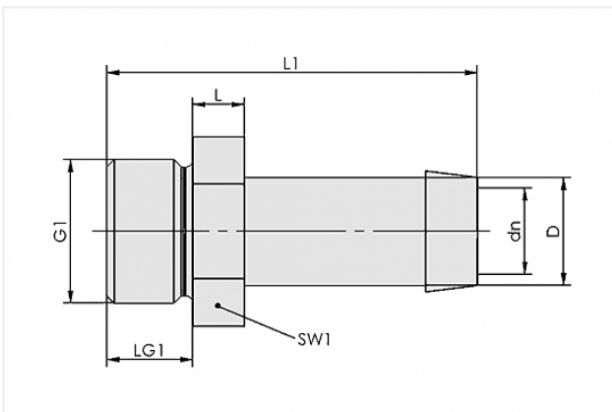

Attribute	Value
-----------	-------

dn	7.5 mm
----	--------

D	8.5 mm
---	--------

G1	G1/4"-M
----	---------

L	5 mm
---	------

L1	42 mm
----	-------

LG1	10 mm
-----	-------

SW1	17 mm
-----	-------

## Technical Data

Attribute	Value
-----------	-------

Material	Brass
----------	-------

## Contact to Schmalz

J. Schmalz GmbH | Johannes-Schmalz-Straße, 72293 Glatten, Deutschland | +49 7443 2403-102 | [customercenter@schmalz.de](mailto:customercenter@schmalz.de)

Attribute	Value
Weight	21 g

## Accessories



### VSL 12-9 PE

Part no. 10.07.09.00050  
Hose for vacuum and compressed-air systems  
External diameter D: 12 mm  
Internal diameter d: 9 mm  
Length (max): 100 m  
Material: PE  
Installation radius (min): 70 mm  
Pressure range (operating pressure):  
-0.95 ... 10.00 bar  
Ambient temperature: -20 ... 70 °C



### VSL 12-9 PU

Part no. 10.07.09.00037  
Hose for vacuum and compressed-air systems  
External diameter D: 12 mm  
Internal diameter d: 9 mm  
Length (max): 50 m  
Material: PU  
Installation radius (min): 70 mm  
Pressure range (operating pressure):  
-0.95 ... 10.00 bar  
Ambient temperature: -20 ... 90 °C



### VSL 15-9 PVC-G

Part no. 10.07.09.00005  
Hose for vacuum and compressed-air systems  
External diameter D: 15 mm  
Internal diameter d: 9 mm  
Length (max): 50 m  
Material: PVC, with textile layer  
Installation radius (min): 50 mm  
Pressure range (operating pressure):  
-0.95 ... 10.00 bar  
Ambient temperature: -20 ... 70 °C

## Contact to Schmalz

