

Plug union, straight

STVI-GE G1/8-IG 8

<https://www.schmalz.com/10.08.02.00151>



Part no.: 10.08.02.00151

Homepage > Vacuum Technology for Automation > Vacuum Components > Filters and Connections > Hoses and Connectors > Screw in Push Fittings > STVI-GE G1/8-IG 8

Screw plug connection, straight



Thread 1: G1/8-F
External hose diameter: 8 mm
Material: Brass
Surface: nickel plated

Design Data

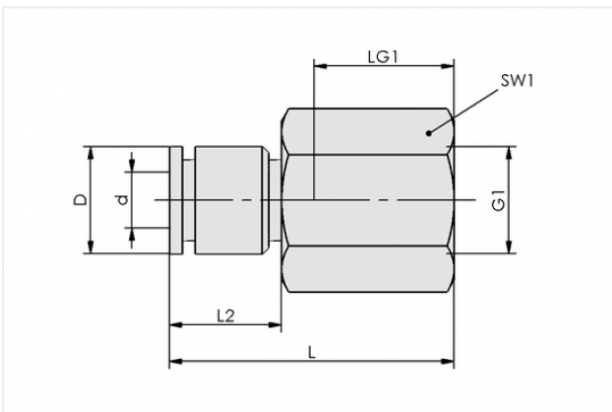

Attribute	Value
-----------	-------

d	8 mm
---	------

D	14.5 mm
---	---------

G1	G1/8"-F
----	---------

L	29.5 mm
---	---------

L2	15 mm
----	-------

LG1	8 mm
-----	------

SW1	14 mm
-----	-------

Technical Data

Attribute	Value
-----------	-------

Hose type	8-6
-----------	-----

Contact to Schmalz

J. Schmalz GmbH | Johannes-Schmalz-Straße, 72293 Glatten, Deutschland | +49 7443 2403-102 | customercenter@schmalz.de

Attribute	Value
Material	Brass
Surface	nickel plated
Pressure range (operating pressure)	0.95 ... 15.00 bar
Ambient temperature	-20 ... 80 °C
for	Hose D = 8 d = 6
Weight	22 g

Accessories

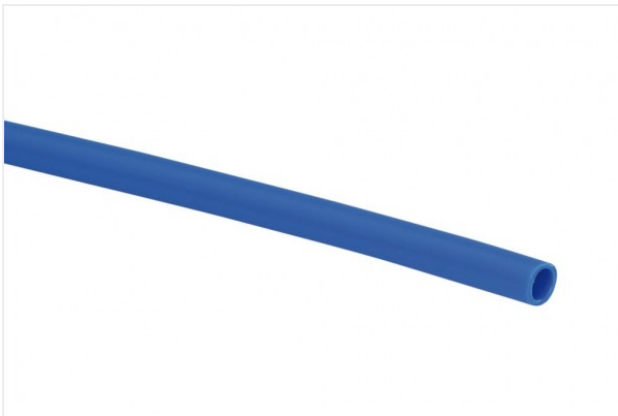

VSL 8-6 PE

Part no. 10.07.09.00015

Hose for vacuum and compressed-air systems

External diameter D: 8 mm

Internal diameter d: 6 mm

Length (max): 100 m

Material: PE

Installation radius (min): 45 mm

Pressure range (operating pressure):

-0.95 ... 10.00 bar

Ambient temperature: -30 ... 70 °C



VSL 8-6 PU

Part no. 10.07.09.00003

Hose for vacuum and compressed-air systems

External diameter D: 8 mm

Internal diameter d: 6 mm

Length (max): 500 m

Material: PU

Installation radius (min): 45 mm

Pressure range (operating pressure):

-0.95 ... 10.00 bar

Ambient temperature: -20 ... 90 °C