

Hose sleeve

ST G1/8-AG 6 MS-V

Part no.: 10.08.03.00154

<https://www.schmalz.com/10.08.03.00154>



Homepage > Vacuum Technology for Automation > Vacuum Components > Filters and Connections > Hoses and Connectors > Accessories for Screw Unions > ST G1/8-AG 6 MS-V

Hose sleeve



Thread 1: G1/8-M
Internal hose diameter: 6 mm
Material: Brass
Surface: nickel plated

Design Data

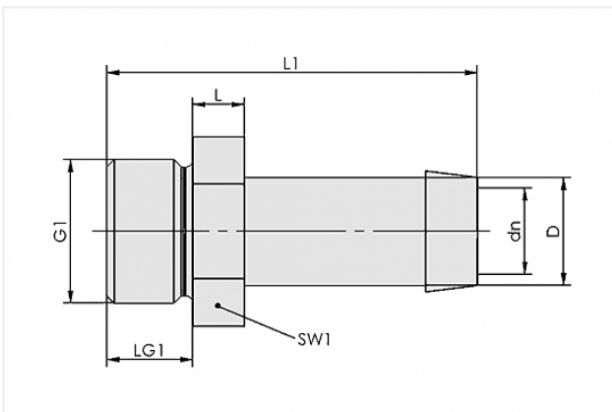

Attribute	Value
dn	4.4 mm
D	5.4 mm
G1	G1/8"-M
L	5 mm
L1	34 mm
LG1	8 mm
SW1	14 mm

Technical Data

Attribute	Value
Material	Brass

Contact to Schmalz

J. Schmalz GmbH | Johannes-Schmalz-Straße, 72293 Glatten, Deutschland | +49 7443 2403-102 | customercenter@schmalz.de

Attribute	Value
Weight	13 g

Accessories



VSL 6-4 PTFE

Part no. 10.07.09.00157
 Hose for vacuum and compressed-air systems
 External diameter D: 6 mm
 Internal diameter d: 4 mm
 Length (max): 50 m
 Material: Polytetrafluorethylene
 Installation radius (min): 35 mm
 Colour: natur
 Ambient temperature: -190 ... 260 °C

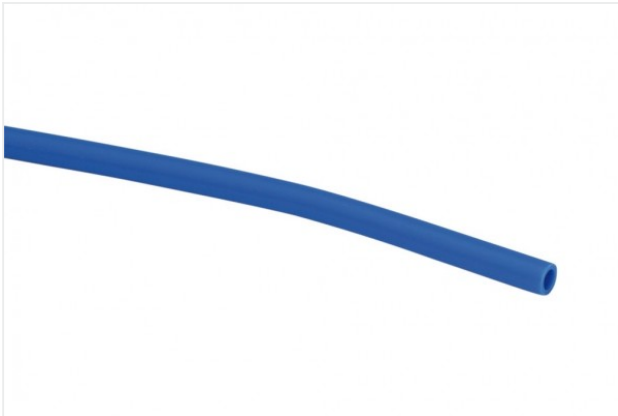

VSL 6-4 PE

Part no. 10.07.09.00014
 Hose for vacuum and compressed-air systems
 External diameter D: 6 mm
 Internal diameter d: 4 mm
 Length (max): 100 m
 Material: PE
 Installation radius (min): 35 mm
 Pressure range (operating pressure):
 -0.95 ... 10.00 bar
 Ambient temperature: -30 ... 70 °C



VSL 6-4 PU

Part no. 10.07.09.00002
 Hose for vacuum and compressed-air systems
 External diameter D: 6 mm
 Internal diameter d: 4 mm
 Length (max): 500 m
 Material: PU
 Installation radius (min): 35 mm
 Pressure range (operating pressure):
 -0.95 ... 10.00 bar
 Ambient temperature: -20 ... 90 °C

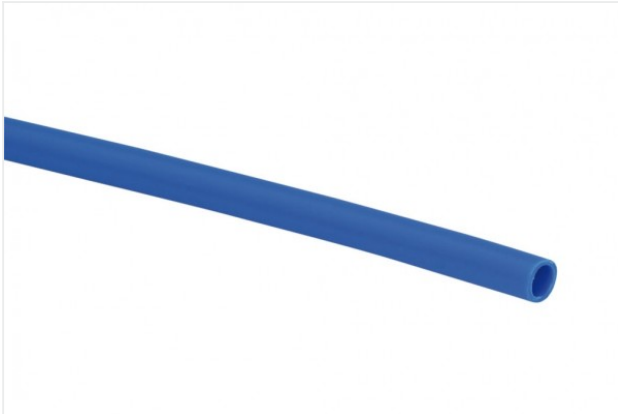
**VSL 8-6 PE**

Part no. 10.07.09.00015

Hose for vacuum and compressed-air systems

External diameter D: 8 mm

Internal diameter d: 6 mm

Length (max): 100 m

Material: PE

Installation radius (min): 45 mm

Pressure range (operating pressure):

-0.95 ... 10.00 bar

Ambient temperature: -30 ... 70 °C

**VSL 8-6 PU**

Part no. 10.07.09.00003

Hose for vacuum and compressed-air systems

External diameter D: 8 mm

Internal diameter d: 6 mm

Length (max): 500 m

Material: PU

Installation radius (min): 45 mm

Pressure range (operating pressure):

-0.95 ... 10.00 bar

Ambient temperature: -20 ... 90 °C