

# Hose sleeve

## ST G1/2-AG 19 MS-V

Part no.: 10.08.03.00163

<https://www.schmalz.com/10.08.03.00163>



Homepage > Vacuum Technology for Automation > Vacuum Components > Filters and Connections > Hoses and Connectors > Accessories for Screw Unions > ST G1/2-AG 19 MS-V

## Hose sleeve



Thread 1: G1/2-M  
Internal hose diameter: 19 mm  
Material: Brass  
Surface: nickel plated

## Design Data

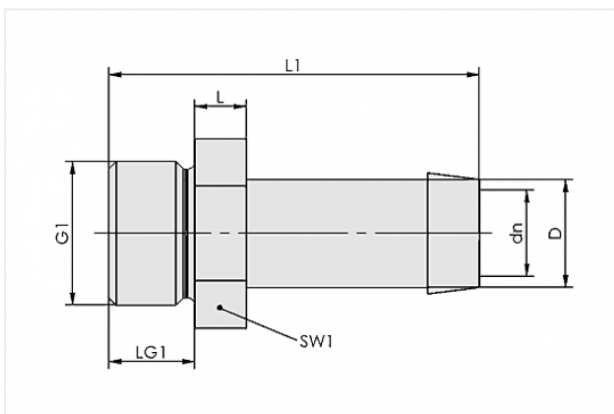

Attribute	Value
-----------	-------

dn	14.3 mm
----	---------

D	19 mm
---	-------

G1	G1/2"-M
----	---------

L	10 mm
---	-------

L1	58 mm
----	-------

LG1	12 mm
-----	-------

SW1	24 mm
-----	-------

## Technical Data

Attribute	Value
-----------	-------

Material	Brass
----------	-------

## Contact to Schmalz

J. Schmalz GmbH | Johannes-Schmalz-Straße, 72293 Glatten, Deutschland | +49 7443 2403-102 | [customercenter@schmalz.de](mailto:customercenter@schmalz.de)

Attribute	Value
Weight	85 g

---

## Accessories



### VSL 26-19 PVC-DS

Part no. 10.07.09.00007

Hose for vacuum and compressed-air systems

External diameter D: 26 mm

Internal diameter d: 19 mm

Length (max): 50 m

Material: PVC, with wire spiral

Installation radius (min): 85 mm

Pressure range (operating pressure):

-0.90 ... 5.00 bar

Ambient temperature: -20 ... 70 °C

---