

**LEVELING CASTOR WITH BOLT HOLE THREAD**

<b>MODEL</b>	With bolt hole thread
<b>DESCRIPTION</b>	Reliable leveling castor with bolt hole thread M12 For fixation to transport and base plates, threaded sleeves or threaded bushes; Roller movement locking by temporary positioning on stamp, actuation of the height adjustment of the stamp via adjustment wheel in the castor housing with wrench
<b>MATERIAL</b>	Bolt hole plate: Steel Housing: Aluminum die-cast Adjustment wheel: Plastic PA Stamp: Rubber NBR Roller: Plastic PA
<b>SURFACE</b>	Bolt hole plate: Zinc plated Housing: Powder coated
<b>COLOR</b>	Housing: White aluminum ≈ RAL 9006 Adjustment wheel: Orange ≈ RAL 2004 Stamp: Black Roller: Black
<b>SET</b>	4 leveling castors with bolt hole thread 4 double threaded bolts M8/M12 4 double threaded bolts M12/M12
<b>PACK QUANTITY</b>	4 pieces
<b>TIP</b>	Compatible transport and base plates with thread M8 or M12 on request

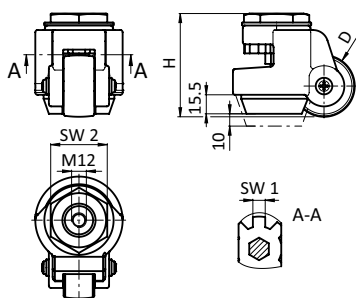

D [mm]	H [mm]	TRAGKRAFT PRO HUBEINHEIT [KG]	SW 1	SW 2	WEIGHT [g]	PART #
50	84	250 (M8/M12) 250 (M12/M12)	11	46	2588.0	098LF050AF46S01
62	103	350 (M8/M12) 500 (M12/M12)	12	65	4688.0	098LF062AF65S01

