

GROMMET BW

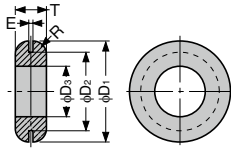

● Flam retardant material (UL94V-0) available by made to order.

| Material | Hardness | Colour |
|----------|----------|--------|
| EPDM | 50° ±5° | Black |

| RoHS | CAD | Item Code | Old Item Code | Item Name | Old Item Name | D ₁ | D ₂ | D ₃ | E | T | R | Weight (g) | Pack (pcs) | Box (packs) | Carton (pcs) | |
|------|-----|-------------|---------------|--------------|---------------|----------------|----------------|----------------|---|----|----|------------|------------|-------------|--------------|---|
| ✓ | 3D | 210-038-040 | 210-040-130 | BW-188-P100 | BW-188 | 18 | 12 | 6 | 1 | 7 | 3 | 2.5 | 100 | 2 | - | |
| ✓ | 3D | 210-038-041 | 210-040-131 | BW-189-P100 | BW-189 | | | | 2 | 8 | | | 100 | 2 | - | |
| ✓ | 3D | 210-038-042 | 210-040-132 | BW-208-P100 | BW-208 | 20 | 14 | 8 | 1 | 7 | | | 100 | 2 | - | |
| ✓ | 3D | 210-038-043 | 210-040-133 | BW-209-P100 | BW-209 | | | | 2 | 8 | | | 100 | 2 | - | |
| ✓ | 3D | 210-038-044 | 210-040-134 | BW-228-P100 | BW-228 | 22 | 16 | 10 | 1 | 10 | | 3.5 | 100 | 2 | - | |
| ✓ | 3D | 210-038-045 | 210-040-135 | BW-229-P100 | BW-229 | | | | 2 | 9 | | | 100 | 2 | - | |
| ✓ | 3D | 210-038-046 | 210-040-136 | BW-2610-P100 | BW-2610 | 26 | 19 | 12 | 1 | 10 | | | 5 | 100 | 2 | - |
| ✓ | 3D | 210-038-047 | 210-040-137 | BW-2611-P100 | BW-2611 | | | | 2 | 11 | | | | 100 | 2 | - |
| ✓ | 3D | 210-038-048 | 210-040-138 | BW-2910-P100 | BW-2910 | 29 | 22 | 14 | 1 | 10 | 6 | 100 | 2 | - | | |
| ✓ | 3D | 210-038-049 | 210-040-139 | BW-2911-P100 | BW-2911 | | | | 2 | 11 | | 100 | 2 | - | | |
| ✓ | 3D | 210-038-050 | 210-040-140 | BW-3210-P100 | BW-3210 | 32 | 25 | 16 | 1 | 10 | 8 | 100 | 2 | - | | |
| ✓ | 3D | 210-038-051 | 210-040-141 | BW-3211-P100 | BW-3211 | | | | 2 | 11 | | 100 | 2 | - | | |
| ✓ | 3D | 210-038-052 | 210-040-142 | BW-3512-P100 | BW-3512 | 35 | 28 | 19 | 1 | 12 | | 9.5 | 100 | 2 | - | |
| ✓ | 3D | 210-038-053 | 210-040-143 | BW-3513-P100 | BW-3513 | | | | 2 | 13 | | | 100 | 2 | - | |
| ✓ | 3D | 210-038-054 | 210-040-144 | BW-4012-P100 | BW-4012 | 40 | 32 | 22 | 1 | 12 | 15 | 100 | 2 | - | | |
| ✓ | 3D | 210-038-055 | 210-040-145 | BW-4013-P100 | BW-4013 | | | | 2 | 13 | | 100 | 2 | - | | |
| ✓ | 3D | 210-038-056 | 210-040-146 | BW-4414-P50 | BW-4414 | 44 | 36 | 25 | 1 | 14 | 20 | 50 | 2 | - | | |
| ✓ | 3D | 210-038-057 | 210-040-147 | BW-4415-P50 | BW-4415 | | | | 2 | 15 | | 50 | 2 | - | | |
| ✓ | 3D | 210-038-058 | 210-040-148 | BW-4814-P50 | BW-4814 | 48 | 40 | 28 | 1 | 14 | | 25 | 50 | 2 | - | |
| ✓ | 3D | 210-038-059 | 210-040-149 | BW-4815-P50 | BW-4815 | | | | 2 | 15 | | | 50 | 2 | - | |
| ✓ | 3D | 210-038-060 | 210-040-150 | BW-5218-P50 | BW-5218 | 52 | 44 | 32 | 1 | 18 | 30 | 50 | 2 | - | | |
| ✓ | 3D | 210-038-061 | 210-040-151 | BW-5219-P50 | BW-5219 | | | | 2 | 19 | | 50 | 2 | - | | |
| ✓ | 3D | 210-038-062 | 210-040-152 | BW-5618-P50 | BW-5618 | 56 | 48 | 36 | 1 | 18 | | 35 | 50 | 2 | - | |
| ✓ | 3D | 210-038-063 | 210-040-153 | BW-5619-P50 | BW-5619 | | | | 2 | 19 | | | 50 | 2 | - | |

※The item codes have been changed.

BEARINGS

SWIVELS

MULTI-PURPOSE LIDS

VENTILATORS

MULTI-PURPOSE CAPS

GROMMETS

CABLE GROMMETS

GASKET

BELT REEL PARTITION

GLASS POINT FIX

OTHERS

LED LIGHTS

GROMMET NG

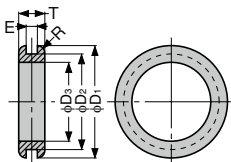

● Flam retardant material (UL94V-0) available by made to order.

| Material | Hardness | Colour |
|----------|----------|--------|
| EPDM | 50° ±5° | Black |

| RoHS | CAD | Item Code | Old Item Code | Item Name | Old Item Name | D ₁ | D ₂ | D ₃ | E | T | R | Weight (g) | Pack (pcs) | Box (pack) | Carton (pack) |
|------|-----|-------------|---------------|--------------|---------------|----------------|----------------|----------------|-----|-----|-----|------------|------------|------------|---------------|
| ✓ | 3D | 210-038-167 | 210-040-111 | NG-937-P100 | NG-937 | 9 | 6 | 3.5 | 1.2 | 3.7 | 0.6 | 0.5 | 100 | 2 | - |
| ✓ | 3D | 210-038-149 | 210-040-112 | NG-1145-P100 | NG-1145 | | | | 1.5 | 4.5 | | | 100 | 2 | - |
| ✓ | 3D | 210-038-150 | 210-040-113 | NG-1160-P100 | NG-1160 | 11 | 8 | 5 | 3 | 6 | | 0.7 | 100 | 2 | - |
| ✓ | 3D | 210-038-151 | 210-040-114 | NG-1345-P100 | NG-1345 | | | | 1.5 | 4.5 | | 100 | 2 | - | |
| ✓ | 3D | 210-038-152 | 210-040-115 | NG-1360-P100 | NG-1360 | 13 | 10 | 7 | 3 | 6 | | 0.5 | 100 | 2 | - |
| ✓ | 3D | 210-038-153 | 210-040-116 | NG-1545-P100 | NG-1545 | | | | 1.5 | 4.5 | | 100 | 2 | - | |
| ✓ | 3D | 210-038-154 | 210-040-117 | NG-1560-P100 | NG-1560 | 15 | 12 | 9 | 3 | 6 | | 1 | 100 | 2 | - |
| ✓ | 3D | 210-038-155 | 210-040-118 | NG-1955-P100 | NG-1955 | | | | 1.5 | 5.5 | | 100 | 2 | - | |
| ✓ | 3D | 210-038-156 | 210-040-119 | NG-1970-P100 | NG-1970 | 19 | 15 | 11 | 3 | 7 | 1.5 | 100 | 2 | - | |
| ✓ | 3D | 210-038-157 | 210-040-120 | NG-2155-P100 | NG-2155 | | | | 1.5 | 5.5 | 100 | 2 | - | | |
| ✓ | 3D | 210-038-158 | 210-040-121 | NG-2170-P100 | NG-2170 | 21 | 17 | 13 | 3 | 7 | 1 | 1.7 | 100 | 2 | - |
| ✓ | 3D | 210-038-159 | 210-040-122 | NG-2355-P100 | NG-2355 | | | | 1.5 | 5.5 | 100 | 2 | - | | |
| ✓ | 3D | 210-038-160 | 210-040-123 | NG-2370-P100 | NG-2370 | 23 | 19 | 15 | 3 | 7 | 1.7 | 100 | 2 | - | |
| ✓ | 3D | 210-038-161 | 210-040-124 | NG-3065-P100 | NG-3065 | | | | 3 | 7 | 2.5 | 100 | 2 | - | |
| ✓ | 3D | 210-038-162 | 210-040-125 | NG-3080-P100 | NG-3080 | 30 | 25 | 20 | 1.5 | 6.7 | 3 | 100 | 2 | - | |
| ✓ | 3D | 210-038-163 | 210-040-126 | NG-3565-P100 | NG-3565 | | | | 3 | 8 | 3.5 | 100 | 2 | - | |
| ✓ | 3D | 210-038-164 | 210-040-127 | NG-3580-P100 | NG-3580 | 35 | 30 | 25 | 1.5 | 6.7 | 4 | 100 | 2 | - | |
| ✓ | 3D | 210-038-165 | 210-040-128 | NG-4275-P50 | NG-4275 | | | | 3 | 8 | 5 | 100 | 2 | - | |
| ✓ | 3D | 210-038-166 | 210-040-129 | NG-4290-P50 | NG-4290 | 42 | 36 | 30 | 1.5 | 7.5 | 7 | 50 | 2 | - | |
| ✓ | 3D | | | | | | | | 3 | 9 | 8 | 50 | 2 | - | |

※The item names have been changed.