

CORNER FASTENERS

CF-201

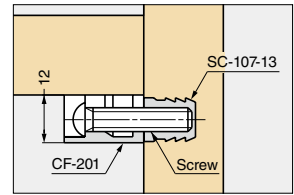
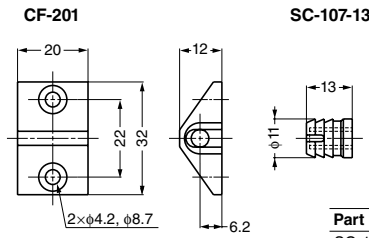

Part Name	Material	Finish/Colour	Size
SC-107-13	Polyamide (PA)	White	M6
Screw	Steel	Yellow Zinc Chromate	M6x25

Item Code	Item Name	Material	Colour	Weight	Box	Carton
120-041-130	CF-201W	Polyamide (PA)	White	10.5 g	100 sets	1000 sets
120-041-101	CF-201BR	Polyamide (PA)	Brown	10.5 g	100 sets	1000 sets

CORNER FASTENERS

CF-203

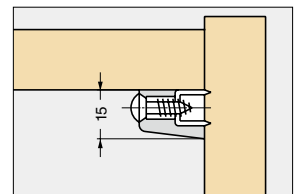
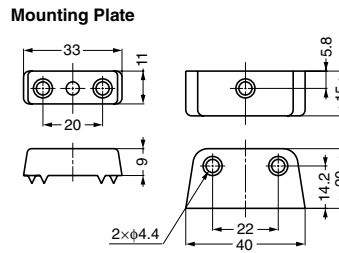

Part Name	Material	Finish	Size
Screw	Steel	Clear Zinc Chromate	5.5x19
Mounting Plate	Steel	Yellow Zinc Chromate	-

Item Code	Item Name	Material	Colour	Weight	Box	Carton
120-041-104	CF-203W	Polystyrene (PS)	White	14 g	80 sets	320 sets
120-041-105	CF-203BR	Polystyrene (PS)	Brown	14 g	80 sets	320 sets

CORNER FASTENERS

CF-228

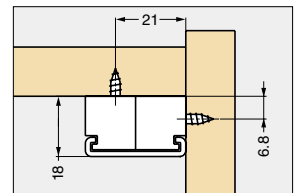
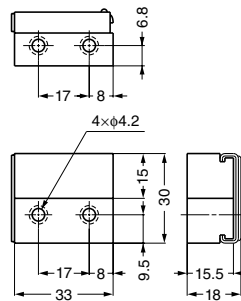
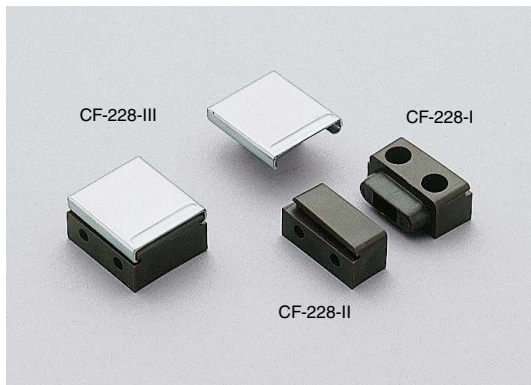

Part Name	Material	Finish/Colour
CF-228-I	Polystyrene (PS)	Brown
CF-228-II	Polystyrene (PS)	Brown
CF-228-III	Steel	Nickel

Item Code	Item Name	Weight	Box	Carton
120-041-116	CF-228	24 g	50 sets	500 sets

CORNER FASTENERS

CF-213

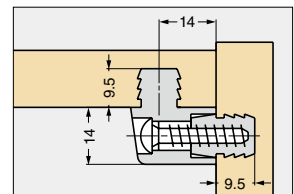
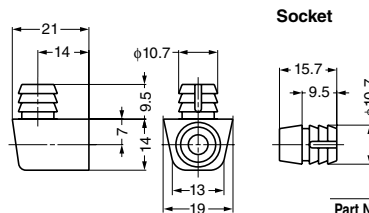

Part Name	Material	Finish/Colour	Size
Socket	Polyamide (PA)	White	Brown 5.6x15.7
Screw	Steel	Yellow Zinc Chromate	Bronze 5.6x23

Item Code	Item Name	Material	Colour	Weight	Box	Carton
120-041-108	CF-213W	Polyamide (PA)	White	10 g	100 sets	1000 sets
120-041-109	CF-213BR	Polyamide (PA)	Brown	10 g	100 sets	1000 sets