

## Cast Nylon Flat Tread Rail Wheels



Nylon wheels are light in weight and are resistant to impact, abrasion, corrosion and the effect of many chemicals.

While unflanged wheels can be used to run on surfaces such as concrete or steel plate, their most common application is paired with a double flanged wheel, the flanged wheel providing guidance and the unflanged wheel allowing a wide tolerance in the pitch of the rails.

**MATERIAL:** Cast Nylon 6

**OPERATING TEMPERATURE RANGE:**

Plain bored or keywayed wheels – 30°C to 80°C

Ball or taper roller bearing wheels – 30°C to 80°C

The 'maximum load rating' given for each wheel is based on the full tread width being in contact with the rail. Working loads must be calculated based on the useable rail width and operating conditions – see 'Design Data' paras. 6.1. and 6.2.

Alternative bore/bearing diameters and alternative bearing types (i.e. bronze bushes, self-lubricating bushes, roller bearings, spherical roller bearings, etc.) are available to order – see pages 23-28.

Plain bore wheels are not drilled and tapped for greasing unless requested at time of order.

**For technical information covering load factors, inertial and rolling resistance, coefficients of friction between wheel and track, and keyway dimensions, see "Design Data" Index on page 20.**

**WHEEL TYPE:**  
**NFT200/60**

See table for full part number

Maximum load rating:

**2350Kg**

See page 21 for load factors

Approximate weight: **2Kg**

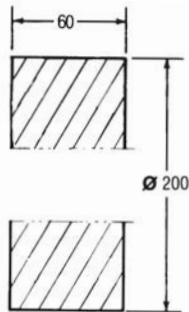

**FULL PART NUMBER FOR ORDERING**

Axle Ø	Plain Bore	Ball Bearing
<b>METRIC AXLE Ø</b>		
30	NFT200/60/PBM30	NFT200/60/BJM30
35	NFT200/60/PBM35	

LOAD LIMITED BY BEARINGS TO: (1) 2040Kg

**WHEEL TYPE:**  
**NFT250/60**

See table for full part number

Maximum load rating:

**2950Kg**

See page 21 for load factors

Approximate weight: **3.2Kg**

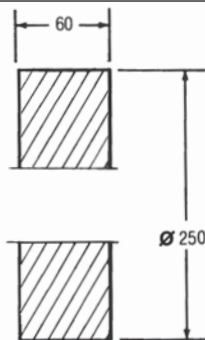

**METRIC AXLE Ø**

35	NFT250/60/PBM35	
40	NFT250/60/PBM40	NFT250/60/BJM40
50	NFT250/60/PBM50	

LOAD LIMITED BY BEARINGS TO: (1) 3384Kg

**WHEEL TYPE:**  
**NFT250/75**

See table for full part number

Maximum load rating:

**3680Kg**

See page 21 for load factors

Approximate weight: **4Kg**

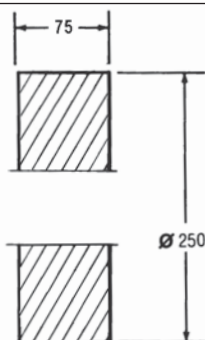

**METRIC AXLE Ø**

35	NFT250/75/PBM35	
40	NFT250/75/PBM40	NFT250/75/BJM40
50	NFT250/75/PBM50	

LOAD LIMITED BY BEARINGS TO: (1) 3384Kg

# Cast Nylon Flat Tread Rail Wheels



## FULL PART NUMBER FOR ORDERING

Axle Ø	Plain Bore	Ball Bearing
<b>METRIC AXLE Ø</b>		
35	NFT250/100/PBM35	
40	NFT250/100/PBM40	
50	NFT250/100/PBM50	NFT250/100/BJM50

LOAD LIMITED BY BEARINGS TO: (1) 4729Kg

### WHEEL TYPE: NFT250/100

See table for full part number

Maximum load rating:  
**4900Kg**

See page 21 for load factors

Approximate weight: **5.5Kg**

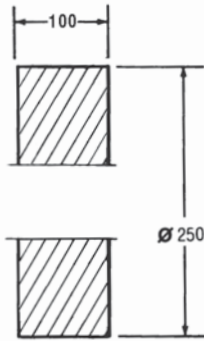

<b>METRIC AXLE Ø</b>		
50	NFT300/100/PBM50	
60	NFT300/100/PBM60	NFT300/100/BJM60

### WHEEL TYPE: NFT300/100

See table for full part number

Maximum load rating:  
**5880Kg**

See page 21 for load factors

Approximate weight: **8Kg**

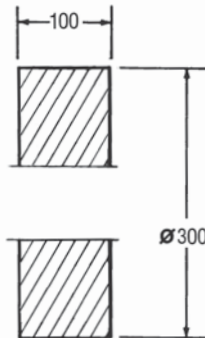

<b>METRIC AXLE Ø</b>		
60	NFT350/100/PBM60	NFT350/100/BJM60
75	NFT350/100/PBM75	

### WHEEL TYPE: NFT350/100

See table for full part number

Maximum load rating:  
**6870Kg**

See page 21 for load factors

Approximate weight: **10.5Kg**

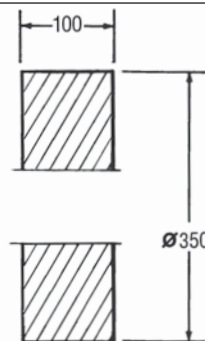

<b>METRIC AXLE Ø</b>		
75	NFT400/100/PBM75	NFT400/100/BJM75

### WHEEL TYPE: NFT400/100

See table for full part number

Maximum load rating:  
**7850Kg**

See page 21 for load factors

Approximate weight: **14Kg**

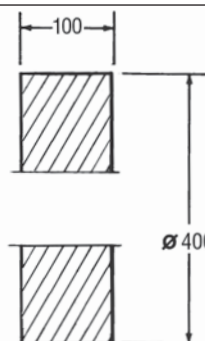

CAST NYLON RANGE