

# LIFT-OFF HINGE



# LSX-100



Right-Hand Opening

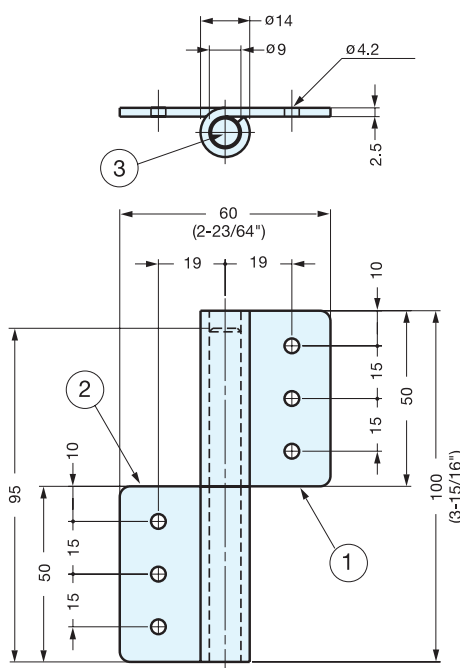

• Left and Right handed available.

Item No.		Weight (g)	Box (pcs)	Carton (pcs)	No.	Part Name	Material	Finish
Left	Right							①
LSX-100L	LSX-100R	170	10	50	②	Body B	-	
					③	Pin		

# LIFT-OFF HINGE (WELD-ON)



# HNH

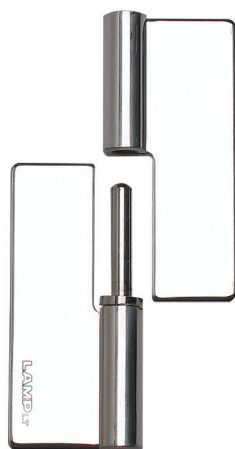

Right-Hand Opening

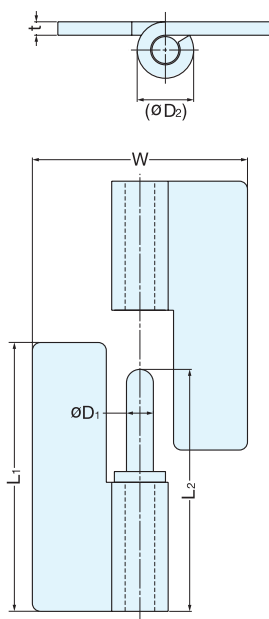

• Weld-on type lift-off hinge.  
• Left and Right handed available.

Material	Finish
304 Stainless Steel	Mirror

Item No.		L <sub>1</sub>	L <sub>2</sub>	W	D <sub>1</sub>	(D <sub>2</sub> )	t	Weight (g)	Box (pcs)	Carton (pcs)
Left	Right									
HNH-50CL	HNH-50CR	50 (1-31/32")	45	40 (1-37/64")	5	10.5	2.5	60	30	240
HNH-65CL	HNH-65CR	65 (2-9/16")	60	50 (1-31/32")	5	10.5	2.5	89	20	160
HNH-75CL	HNH-75CR	75 (2-61/64")	70	70 (2-3/4")	6	12.0	3.0	165	10	80
HNH-100CL	HNH-100CR	100 (3-15/16")	90	82 (3-15/64")	8	16.0	4.0	347	5	40