

STAINLESS STEEL HANDLE H-42-F14

SUS316

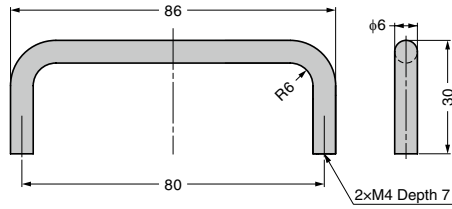

RtHS	CAD	Item Code	Item Name	Material	Finish	Weight (g)	Box (pcs)	Carton (pcs)
		100-019-233	H-42-F14	Stainless Steel (SUS316)	Polished	25	50	250

STAINLESS STEEL HANDLE MG

SUS

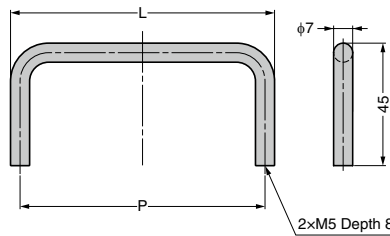

- Higher profile allows for easy gripping with glove on.
- MG-68 is compliant with SEMI standard (SEMI S8-0307).

RtHS	CAD	Item Code	Item Name	Material	Finish	L	P	Weight (g)	Box (pcs)	Carton (pcs)
		100-010-488	MG-68	Stainless Steel (SUS304)	Polished	75	68	42	100	300
		100-010-073	MG-90			97	90	48	100	300

HANDLE T-100-8

SUS

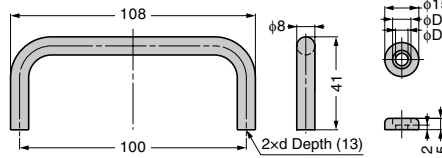

- Higher profile allows for easy gripping with glove on.

RtHS	CAD	Item Code	Item Name	Material	Finish	d	D ₁	D ₂	Weight (g)	Box (pcs)	Carton (pcs)
		100-010-224	T-100-8S	Stainless Steel (SUS304)	Polished	M5	5.5	8.2	72	100	300
		100-019-855	T-100-8CR	Brass	Chrome	M4	4.5	8	78	50	-

STAINLESS STEEL HANDLE H-75-BL-100

NSF SUS

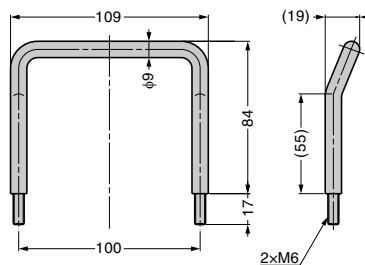

- Angled grip for a comfortable grip.

[Remarks]

- Please use washers for wood or melamine resin. (Not included)

RtHS	CAD	Item Code	Item Name	Material	Finish	Weight (g)	Box (pcs)	Carton (pcs)
		100-010-604	H-75-BL-100	Stainless Steel (SUS304)	Polished	130	20	80