

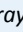

**GREIFSCHALE 105 × 130 × 50 (SET)****GRAB TRAY 105 × 130 × 50 (SET)**

| | | | |
|----------------------|-----------------------------------------------------------------------------------------------------------------------------------------------------------------------------------------------------------------------------------------------------------------------------------------------------------------------------------------------------------------------|----------------------|-----------------------------------------------------------------------------------------------------------------------------------------------------------------------------------------------------------------------------------------------------------------------------------------------------------------------------------------------------|
| Ausführung | Nut 8, 10 | Model | Slot 8, 10 |
| Beschreibung | zur Bereitstellung von Kleinteilen auf Vereinzelfläche und selektiver Aufnahme kleinster Komponenten; durch einfaches Einschwenken in die Profilnut montierbar; gut sichtbares Kennzeichnungsfeld erlaubt eine sichere Zuordnung | Description | To provide hardware and small parts on sorting area for selective grabbing of smallest components; simple assembly by swiveling into the profile slot; the clearly visible label area enables secure part identification |
| Material | Greifschale Standard-Ausführung: Kunststoff PA, glasfaserverstärkt Greifschale  elektrostatisch entladende Ausführung: Kunststoff PA, kohlefaserverstärkt Sichtfenster: Kunststoff PC Etikett: Karton 250 g/m ² Elastikpuffer: Kunststoff PU, ≈ 65-70 Shore A | Material | Grab tray standard version: Plastic PA, glass fiber reinforced Grab tray  electrostatically discharging version: Plastic PA, carbon fiber reinforced Label window: Plastic PC Label: Carton 250 g/m ² Bumper: Plastic PU, ≈ 65-70 Shore A |
| Set | 1 Greifschale, 1 Sichtfenster, 1 Etikett, 4 Elastikpuffer, selbstklebend | Set | 1 grab tray, 1 label window, 1 label, 4 bumper, self-adhesive |
| Liefereinheit | 10 Stück | Pack Quantity | 10 pieces |
| Extras | weitere Farben auf Anfrage | Specials | Other colors on request |

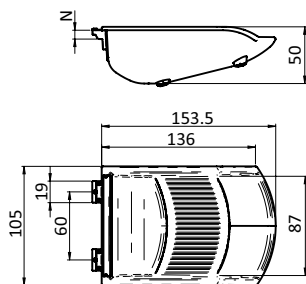

| Greifschale 105 × 130 × 50 (Set) Grab Tray 105 × 130 × 50 (Set) | N | Farbe | Gewicht [g] Weight [g] | Teil-Nr. Part # |
|----------------------------------------------------------------------------------------------------------------------------------------------------|----|-------------------------------|---------------------------|--------------------------|
| | 8 | schwarz <i>Black</i> | 120.1 | 061MGT2D391N08 |
| elektrostatisch entladend  <i>electrostatically discharging</i> | 8 | schwarz <i>Black</i> | 102.4 | 061MGT2D391N08ESD |
| | 8 | gelb ≈ RAL 1003 <i>Yellow</i> | 120.1 | 061MGT2D311N08 |
| | 8 | rot ≈ RAL 3020 <i>Red</i> | 120.1 | 061MGT2D331N08 |
| | 8 | grün ≈ RAL 6032 <i>Green</i> | 120.1 | 061MGT2D361N08 |
| | 8 | grau ≈ RAL 7042 <i>Gray</i> | 120.1 | 061MGT2D374N08 |
| | 10 | schwarz <i>Black</i> | 120.7 | 061MGT2D391N10 |
| elektrostatisch entladend  <i>electrostatically discharging</i> | 10 | schwarz <i>Black</i> | 106.1 | 061MGT2D391N10ESD |
| | 10 | gelb ≈ RAL 1003 <i>Yellow</i> | 120.7 | 061MGT2D311N10 |
| | 10 | rot ≈ RAL 3020 <i>Red</i> | 120.7 | 061MGT2D331N10 |
| | 10 | grün ≈ RAL 6032 <i>Green</i> | 120.7 | 061MGT2D361N10 |
| | 10 | grau ≈ RAL 7042 <i>Gray</i> | 120.7 | 061MGT2D374N10 |