

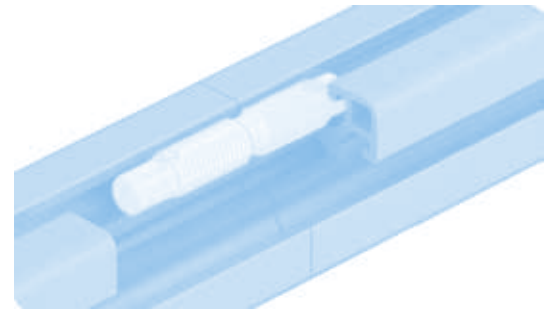

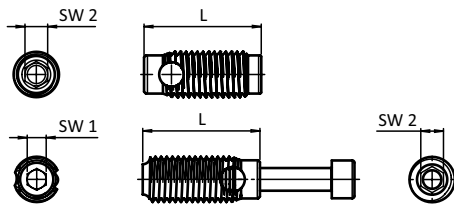





AUTOMATIK-STOßVERBINDER

AUTOMATIC BUTT CONNECTOR

Ausführung Edelstahl**Beschreibung** zur schnellen stirnseitigen Verbindung von zwei Aluminiumprofilen ohne Profilbearbeitung; selbstschneidendes Gewinde**Material** Edelstahl**Liefereinheit** 100 Stück**Hinweis** * passende Abdeckkappe siehe Seite 436**Model** Stainless steel**Description** To face-to-face connect two aluminum profiles fast, assembly without machining; self-cutting thread**Material** Stainless steel**Pack Quantity** 100 pieces**Tip** * Compatible cover cap screw see page 436

Automatik-Stoßverbinder <i>Automatic Butt Connectors</i>	D [mm]	L [mm]	SW1	SW2	ESD	Nut Slot	Profilbreite Profile Width	Schraube Screw	Gewicht [g] Weight [g]	Profil Profile	Teil-Nr. Part #
Gewinde-Schneidhülse <i>Threaded cutting sleeve</i>	7.0	24.0		4		5	20		2.7	I	099GS051M4E
	10.0	27.0		5		6	30		7.4	I	099GS061M5E
	12.0	31.0		6		8	40		13.0	I	* 099GS081M6E
inkl. Montageset mit Schraube und Schneidhülse <i>With assembly set, incl. screw and threaded cutting sleeve</i>	7.0	24.0	3	4		5	20	M4 × 40	10.0	I	099G051M4E
	10.0	27.0	4	5		6	30	M5 × 45	24.0	I	099G061M5E
	12.0	31.0	5	6		8	40	M6 × 50	43.0	I	* 099G081M6E