

VERBINDERPLATTE

CONNECTION PLATE

Ausführung Aluminium
Beschreibung zur rechtwinkligen Verbindung von zwei Aluminiumprofilen
Material Aluminium
Oberfläche eloxiert
Liefereinheit 10 Stück
Extras weitere Oberflächen, weitere Farben auf Anfrage

Model Aluminum
Description To connect two aluminum profiles at right angles
Material Aluminum
Surface Anodized
Pack Quantity 10 pieces
Specials Other surfaces, other colors on request

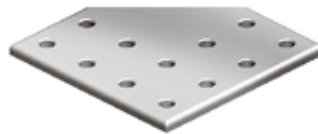
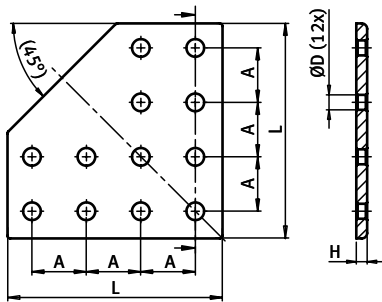

| Verbinderplatte Connection Plate | A [mm] | H [mm] | L [mm] | ØD [mm] | Gewicht [g] Weight [g] | Teil-Nr. Part # |
|-------------------------------------|-------------|-----------|--------------|------------|---------------------------|--------------------|
| 80/80 | 20.0 | 4.0 | 79.0 | 5.5 | 55.0 | 093VL8080D |
| 120/120 | 30.0 | 5.0 | 118.5 | 7.0 | 158.0 | 093VL120120D |
| 152/152 - 5.98"/5.98" | 38.1 (1.5") | 6.0 | 150.0 (5.9") | 9.0 | 305.0 | 093VL152152D |
| 160/160 | 40.0 | 6.0 | 158.0 | 9.0 | 340.0 | 093VL160160D |
| 180/180 | 45.0 | 6.0 | 178.0 | 9.0 | 435.0 | 093VL180180D |