

Nutmütern und -schrauben *T-Nuts and T-Bolts*Nutensteine *T-slot Nuts*Nut 8 *Slot 8***NUTENSTEIN 13,7 × 7,0 MM, EINSCHWENKBAR****ROLL-IN T-SLOT NUT 13.7 × 7.0 MM**

| | | | |
|----------------------|---|----------------------|--|
| Ausführung | Nut 8, mit Federkugel, Stahl / Edelstahl | Model | Slot 8, with spring loaded ball, steel / stainless steel |
| Beschreibung | einschwenkbarer Nutenstein mit Federkugel | Description | Roll-in T-slot nut with spring loaded ball |
| Material | Nutenstein: Stahl, verzinkt / Edelstahl 1.4301 / 1.4305 Profil: Stahl / Edelstahl 1.4301 / 1.4305, blank, ohne Gewinde Kugel: Edelstahl | Material | T-slot nut: Zinc plated steel / stainless steel SS304 / SS303 Rod: Steel / stainless steel SS304 / SS303 plain, without thread Ball: Stainless steel |
| Liefereinheit | 100 Stück | Pack Quantity | 100 pieces |
| Extras | ⚡ elektrostatisch entladend, verschiedene Längen mit mehreren Gewinden in unterschiedlichen Größen auf Anfrage | Specials | ⚡ electrostatically discharging, different lengths with multiple threads in different sizes available on request |

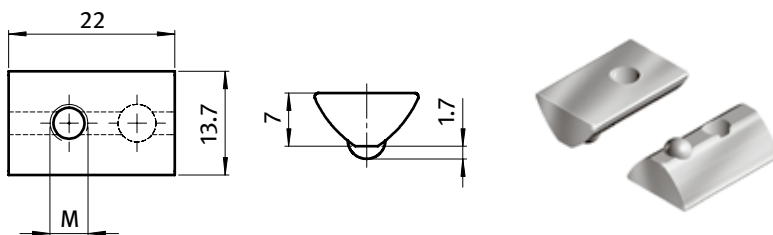

| Nutenstein <i>T-slot Nut</i> | ESD | Größe <i>Size</i> | Gewicht [g] <i>Weight [g]</i> | Profil <i>Profile</i> | Teil-Nr. <i>Part #</i> |
|--|--|----------------------|----------------------------------|--------------------------|---------------------------|
| Stahl <i>Steel</i> | | M3 | 10.9 | I | 096003 |
| | | M4 | 10.8 | I | 096004 |
| | | M5 | 10.5 | I | 096005 |
| | | M6 | 9.9 | I | 096006 |
| | | M8 | 9.0 | I | 096008 |
| | | 10-32 UNF | 10.9 | I | 09600U10-32 |
| Stahl <i>Steel</i> | ⚡ elektrostatisch entladend <i>electrostatically discharging</i> | M4 | 10.8 | I | 096004S01 |
| | ⚡ elektrostatisch entladend <i>electrostatically discharging</i> | M5 | 10.5 | I | 096005S01 |
| | ⚡ elektrostatisch entladend <i>electrostatically discharging</i> | M6 | 9.9 | I | 096006S01 |
| | ⚡ elektrostatisch entladend <i>electrostatically discharging</i> | M8 | 9.0 | I | 096008S01 |
| Edelstahl <i>Stainless steel</i> | | M3 | 10.9 | I | 096003E |
| | | M4 | 10.8 | I | 096004E |
| | | M5 | 10.5 | I | 096005E |
| | | M6 | 9.9 | I | 096006E |
| | | M8 | 9.0 | I | 096008E |
| Profil, Stahl <i>Rod, steel</i> | | 1500 mm | 799.5 | I | 096000.1500 |
| Profil, Edelstahl <i>Rod, stainless steel</i> | | 1500 mm | 799.5 | I | 096000E.1500 |