

VERTICAL CLAMPS SAFETY INTERLOCK+

VERTICAL MODELS

V150/2BKL - V450/2BKL

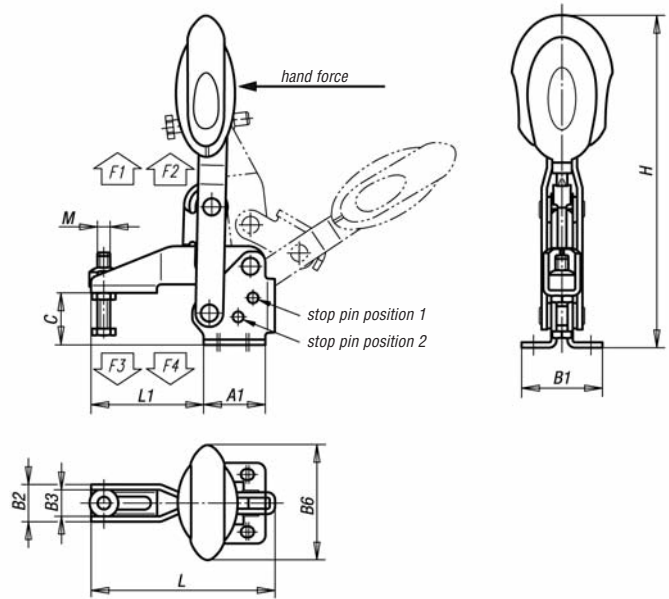

Material:
Steel, Polyamide handle, TPE unlocking bracket.

Surface finish:
Nitro carburized and black oxidized.

Arm:
The spindle position is adjustable along the arm.

Base:
Flanged.

Supplied complete with:
Setscrew & Nut.

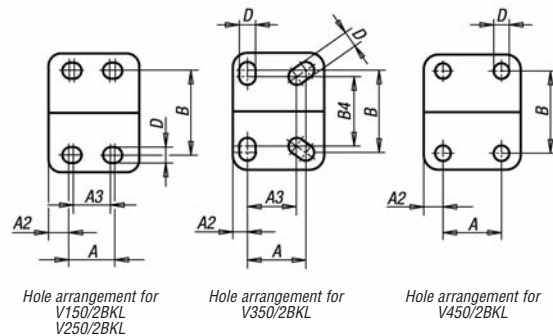

Includes an internal bar lock with automatic safety and maintenance free high quality swivel bushings

Order No	Arm opens through, Position 1	Arm opens through, Position 2	Arm opens through, pin removed	Handle opens through, Position 1	Handle opens through, Position 2	Handle opens through, pin removed	Handforce daN	Holdingforce F1 daN	Holdingforce F2 daN	Clampingforce F3 daN	Clampingforce F3 daN
V150/2BKL	56°	83°	156°	46°	56°	84°	16	135	165	92	105
V250/2BKL	13°	93°	157°	26°	61°	86°	19	200	280	94	135
V350/2BKL	6°	97°	175°	19°	59°	91°	25	250	450	150	280
V450/2BKL	11°	88°	163°	24°	60°	91°	30	300	550	140	280

Order No	M	A	A1	A2	A3	B	B1	B2	B3	B4	B6	C	D	H	L	L1
V150/2BKL	M6x35	14	29	7	12	27	38	17.5	12.4	-	53.4	24.7	5.5	162.9	86.5	53.0
V250/2BKL	M8x45	21	39	9	19	32	45	20.6	15.5	-	51.1	32.7	6.8	191.4	107.0	62.0
V350/2BKL	M10x55	32	50	8	27	45	64	25.5	18.4	38	56.5	38.7	9	230.5	153.0	95.0
V450/2BKL	M12x70	32	53	10.5	-	45	63	28	20.9	-	56.5	46.7	8.8	249.1	173.5	113.5