

REVISION HISTORY			
REV	DATE	BY	DESCRIPTION
B	13AUG2015	CMS/NJF	PRN: P2015-1657

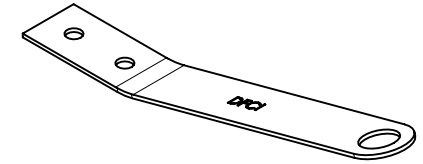

SCALE 1:1

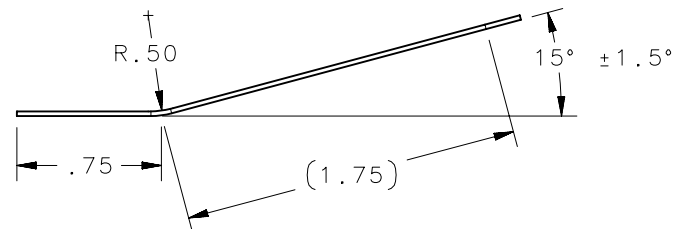
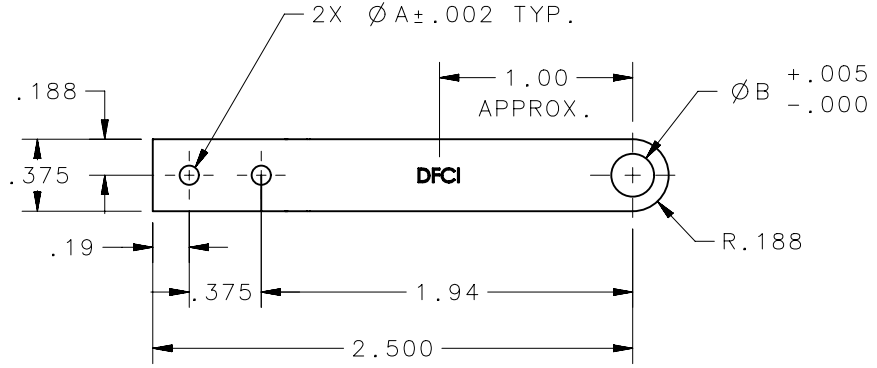

FLAT PATTERN

FINAL FORM

- NOTES:
- A. TYPE 302 STAINLESS STEEL, SPRING TEMPER.
 - B. BLACK OXIDE, MIL-D-13924D, RoHS COMPLIANT.

1224-1031-1-SS	D4-X1031-1SSNA	SEE NOTE A		0.100	0.223
1224-1031-1-SS-BOF	D4-X1031-1SSBANA	SEE NOTE A	SEE NOTE B	0.100	0.223
1224-1031-2-SS-BOF	D4-X1031-2SSBANA	SEE NOTE A	SEE NOTE B	0.096	0.255
1224-1031-SS	D4-X1031SSNA	SEE NOTE A		0.096	0.223
DFCI PART NUMBER	SOUTHCO PART NUMBER	MATERIAL	FINISH	DIM A	DIM B

THIRD ANGLE PROJECTION		 CONNECT • CREATE • INNOVATE			
INCHES [MM]					
TOLERANCES UNLESS OTHERWISE NOTED		DESCRIPTION			
X° ±2°		BLADE			
X/X ±1/32		SIZE	SYSTEM	DWG NO.	
.XX ±.015		A	NX	J-D4-X1031NA	
.XXX ±.010		DRAWN BY		DATE	SHEET
PER ASME Y14.5M-1994		CMS/NJF		27JUL2015	1 OF 1
<small>PROPRIETARY ITEM</small> <small>EXCEPT FOR USES EXPRESSLY GRANTED IN WRITING, INFORMATION DISCLOSED HEREON IS CONFIDENTIAL AND ALL RIGHTS, PATENT AND OTHERWISE, ARE RESERVED BY SOUTHCO, INC.</small>		SCALE 1:1			