

### Opening spring hinges 120 mm long



Opening spring force:

M(0°): 0.85 N.m / M(90°): 0.56 N.m / M(180°): 0.28 N.m

Stainless steel spring.



Part number	Material	Finish	A	B	C	D	F	G	S	Note	Weight (g)
71-1-3860	5754 alu	raw	120	40	1.5	4				undrilled	45
71-1-3861	5754 alu	raw	120	40	1.5	4	22.7	60	4	drilled	45
NS 71-1-3887	5754 alu	raw	120	40	1.5	4	22.7	60	4	with M5 studs	57

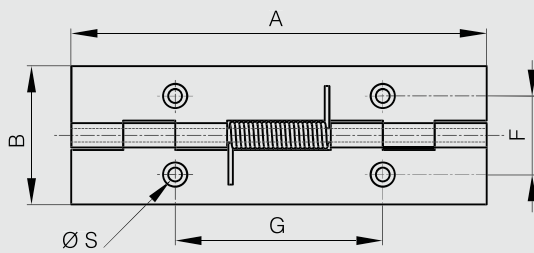

71-1-3793 & 71-1-3805 & 71-1-3861

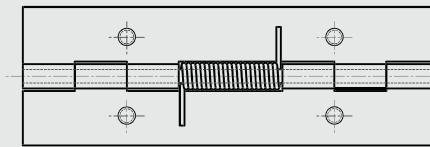

71-1-3879 & 71-1-3885 & 71-1-3887

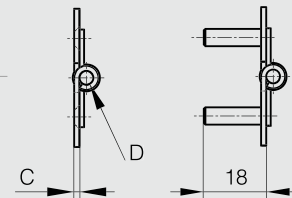

### Closing spring hinges 120 mm long



Closing spring force:

M(0°): 0.28 N.m / M(90°): 0.56 N.m / M(180°): 0.85 N.m

Stainless steel spring.



Part number	Material	Finish	A	B	C	D	F	G	S	Note	Weight (g)
71-1-3862	5754 alu	raw	120	40	1.5	4				undrilled	45
71-1-3863	5754 alu	raw	120	40	1.5	4	22.7	60	4	drilled	45
NS 71-1-3888	5754 alu	raw	120	40	1.5	4	22.7	60	4	with M5 studs	57

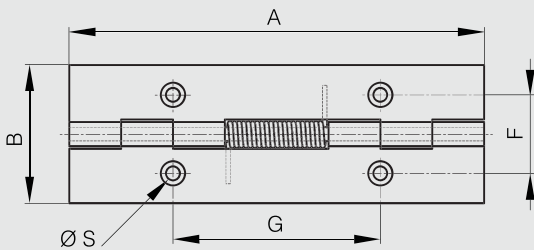

71-1-3796 & 71-1-3808 & 71-1-3863

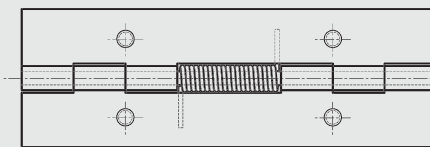

71-1-3880 & 71-1-3886 & 71-1-3888

