



Stainless steel range - Hinges

Cranked hinges for surface mounted doors

Small butt hinge with one cranked leaf and removable pin 50 mm

Removable pin.

Door thickness: max. 20 mm.



Part number	Material	Finish	A	B	C	D	E	S	Weight (g)
62-1-3301	430 stainless steel	polished	50	44.8	1.2	3	19	4.8	33

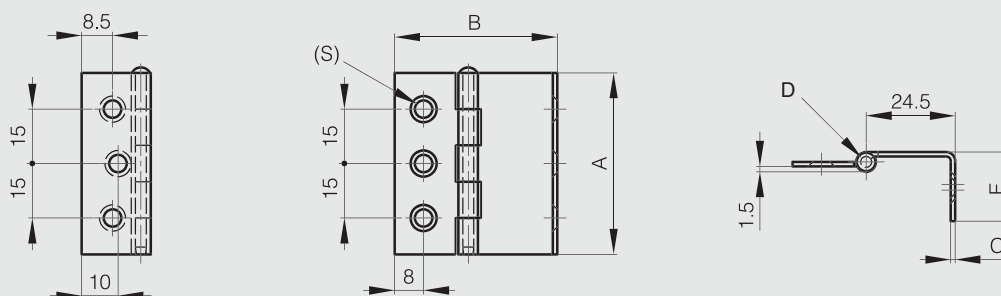

Small butt hinges with one cranked leaf 38 mm



Part number	Material	Finish	A	B	C	D	E	F	G	S	Pin material	Weight (g)
62-1-3628	316L stainless steel	raw	38	15	1.5	3	14	31	17	4.5	316L stainless steel	26

