

Carbon Kevlar hinges - 36 mm width

Hinge is constructed of rigid leaves and a flex unit.
 The rigid leaves are woven carbon fibre in an epoxy matrix.
 The Kevlar flex units are impregnated with a flexible urethane.
 Design for bonding.
 No metallic component. Ultra light, ultra thin.

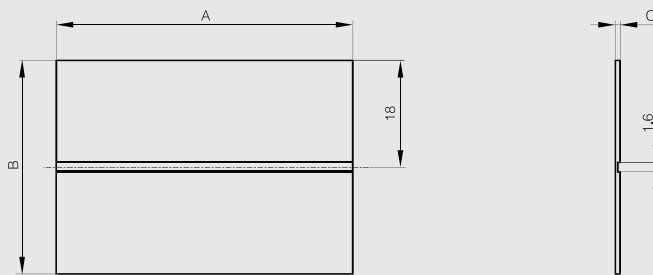

Part number	Material	Finish	A	B	C	Weight (g)
54-1-3600	carbon / Kevlar	black	50	36	0.8	2
54-1-3601	carbon / Kevlar	black	100	36	0.8	3



Carbon Kevlar hinges - 50 mm width

Hinge is constructed of rigid leaves and a flex unit.
 The rigid leaves are woven carbon fibre in an epoxy matrix.
 The Kevlar flex units are impregnated with a flexible urethane.
 Design for bond or screws assembly.
 Part number 54-7-3602 tested to over one million cycles through an 80° arc.
 No metallic component. Ultra light, ultra thin.



Part number	Material	Finish	A	B	C	Weight (g)
54-1-3602	carbon / Kevlar	black	50	50	1.5	4
54-1-3603	carbon / Kevlar	black	100	50	1.5	10
54-1-3604	carbon / Kevlar	black	600	50	1.5	51

