

Hinges with dual function

Spring hinges - Polymer

Polymer hinges with or without adjustable spring torque



Hinge with adjustable spring torque.

Opening spring force on delivery:

M(0°): 0.75 N.m / M(90°): 0.5 N.m / M(180°): 0.25 N.m

Recommended maximum torque for opening spring: 1.1 N.m at 60° (4 clicks).

Closing spring force on delivery:

M(0°): 0 N.m / M(90°): 0.25 N.m / M(180°): 0.5 N.m

Recommended maximum torque for closing spring: 1.1 N.m at 120° (6 clicks).

Material: 30% GF reinforced PA 6.

Spring in Bezinal steel.

Other components in POM.

Spring force adjusted with a T27 Torx key in option (part number 99-1-3729).

Adjustment instructions: scan the QR code.



	Part number	Material	Finish	A	B	C	D	Note	Weight (g)
NEW	54-1-3552	polymer	black	75	65	5	13	opening spring	45
NEW	54-1-3553	polymer	black	75	65	5	13	closing spring	45
NEW	54-1-3554	polymer	black	75	65	5	13	without spring	38

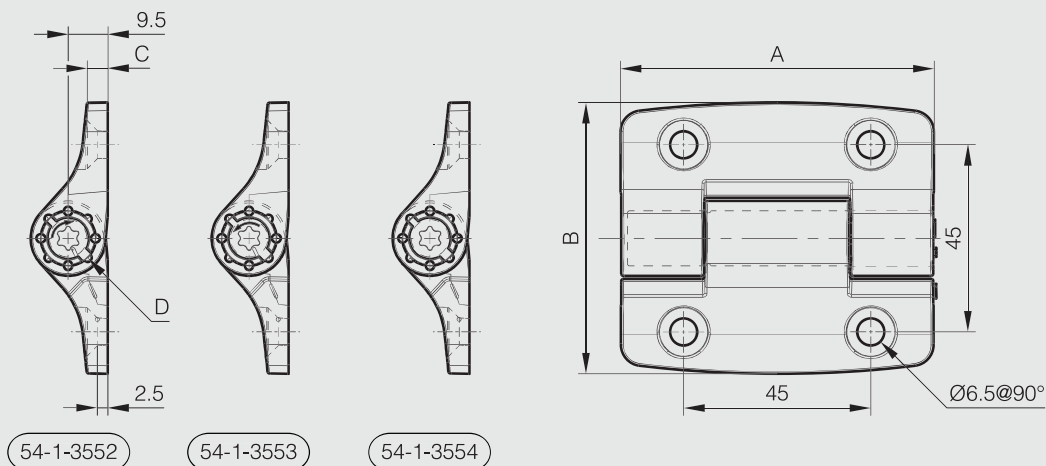

Instructions



opening spring



closing spring