

Continuous hinge with two cranked leaves

Opening angle 270°. Other lengths and pin materials are available on request.
Specific drilling requirements are also available on request.

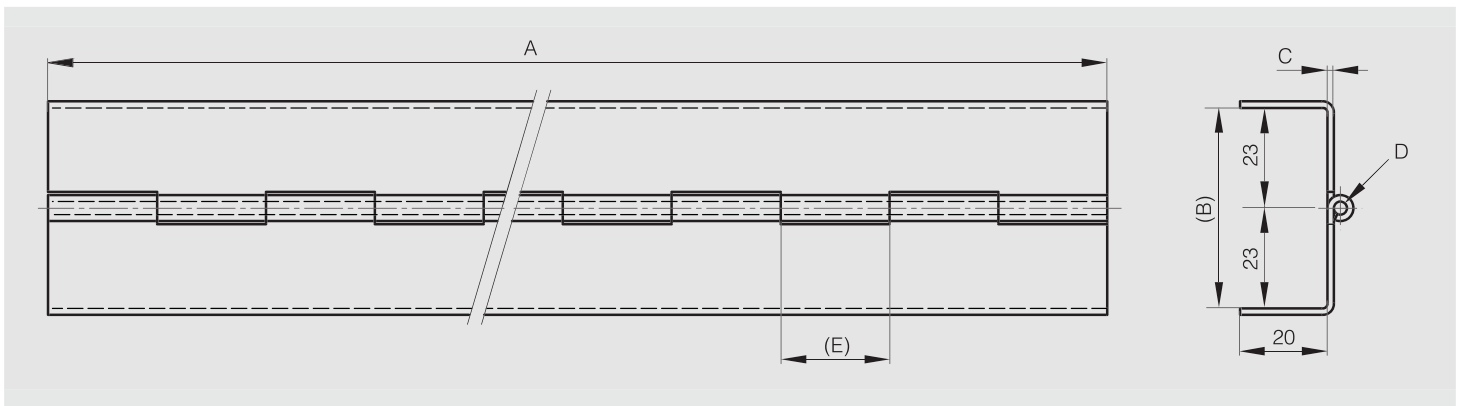

Part number	Material	Finish	A	B	C	D	E	Pin material	Note	Weight (g)
39-1-3634	steel	zinc plated	1995	46	1.5	3	25	304 stainless steel	undrilled	1910
39-1-3635	304 stainless steel	raw	2000	46	1.5	3	25	304 stainless steel	undrilled	1944



Rolled knuckle continuous hinge "Imperial" dimension



Part number	Material	Finish	A	B	C	D	E	Pin material	Note	Weight (g)
42-1-4089 UK	304 stainless steel	raw	6'	1" 1/4	0.04"	0.08"	5/8"	stainless steel	undrilled	500
42-1-4094 UK	304 stainless steel	raw	7'	3"	1/16"	5/32"	5/8"	stainless steel	undrilled	2400
42-1-4095 UK	304 stainless steel	raw	7'	5"	0.08"	1/4"	1" 1/4	stainless steel	undrilled	5000
42-1-4096 UK	304 stainless steel	raw	6'	1"	0.04"	0.08"	5/8"	stainless steel	undrilled	500
42-1-4097 UK	304 stainless steel	raw	6'	2' 3/4	1/16"	5/32"	5/8"	stainless steel	undrilled	1900
42-1-4219 UK	304 stainless steel	raw	6'	2"	1/16"	5/32"	5/8"	stainless steel	undrilled	1500
42-1-4220 UK	304 stainless steel	raw	7'	2' 1/4	1/16"	5/32"	5/8"	stainless steel	undrilled	2000
42-1-4221 UK	304 stainless steel	raw	6'	2' 1/2	1/16"	5/32"	5/8"	stainless steel	undrilled	1800
42-1-4346 UK	304 stainless steel	raw	6'	1" 1/4	3/64"	1/8"	3/4"	stainless steel	undrilled	810
42-1-4347 UK	304 stainless steel	raw	6'	1" 1/2	3/64"	1/8"	3/4"	stainless steel	undrilled	940
42-1-4348 UK	304 stainless steel	raw	6'	2"	3/64"	1/8"	3/4"	stainless steel	undrilled	1112

