

### Drop handles - load 35 kg or 45 kg

With 90° stop.

STEEL

Part number	Material	Finish	A	B	C	D	E	S	Note	Weight (g)
19-7-3515	steel	zinc plated	142	45	120	75	8	5.2	load: 35 kg	115
19-7-3535	steel	zinc plated	160	46	138	94	8	5.2	load: 45 kg	142
19-7-3649	steel	zinc plated	187	49.6	162	109	8	5.2	load: 45 kg	155

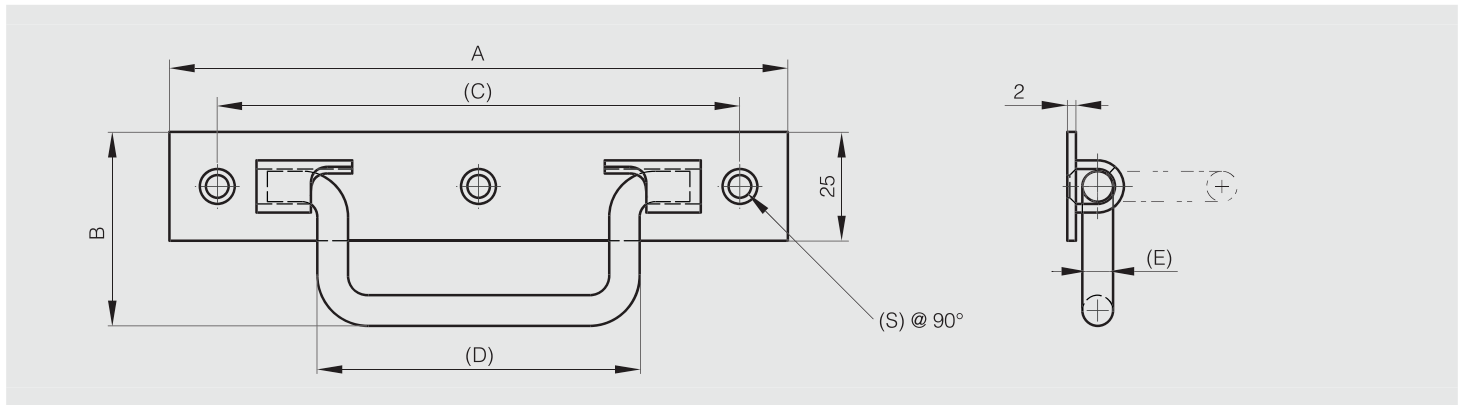

### Drop handle with chamfered angles - load 35 kg

With 90° stop.

STAINLESS STEEL  
RoHS

Part number	Material	Finish	A	B	C	D	E	S	Note	Weight (g)
19-7-3690	304 stainless steel	raw	158	54	130	89	7	5.2	load: 35 kg / chamfered angles	120

