



Touch latches

Screw mount counter plate for part number 16-7-4302



Part number	Material	Finish	Weight (g)
16-7-4303	POM	black	0.4

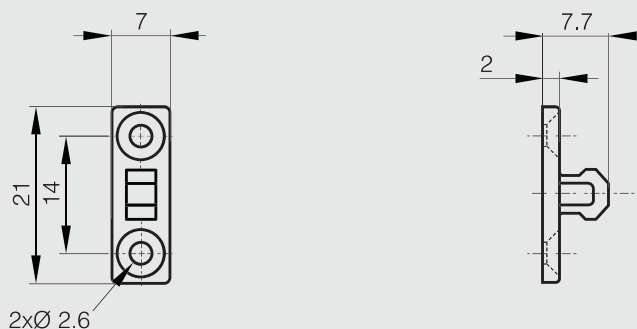

Touch latch - Snap-in installation

Compact design with strong retaining force (3.5 kg).
 Snap-in style catch. For sheet metal thickness 2 mm.
 Strike sold separately.
 Polymer material: PBT, PA and PCL.



Part number	Material	Finish	A	B	C	Force	Weight (g)
16-7-4300	polymer	black	27.3	14	9.8	3.5kg	2

