



## Standard toggle latches

### Toggle latches without strike - 58.1 mm

This latch is used with strike, part numbers 16-7-3873 and 16-7-3874.



Part number	Material	Finish	A	B	C	Weight (g)
16-7-3875	steel	zinc plated	58.1	23.4	12.7	32
16-7-3876	304 stainless steel	raw	58.1	23.4	12.7	32

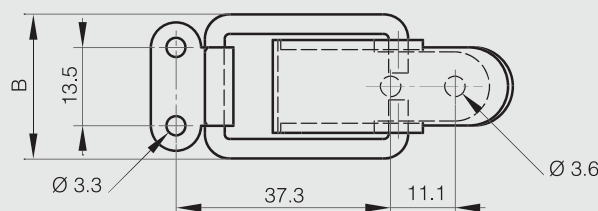
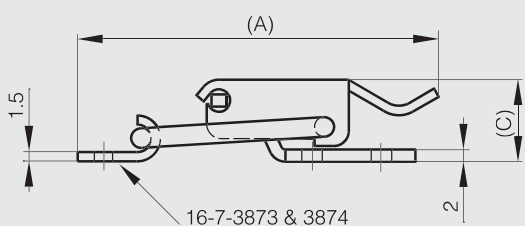

### Strikes for part numbers 16-7-3875 and 16-7-3876



Part number	Material	Finish	Weight (g)
16-7-3873	steel	zinc plated	4
16-7-3874	304 stainless steel	raw	4

