



## Toggles latches

### Spring loaded and padlockable toggle latch - 52 mm

Dimension A (52 mm) without tension. Dimension A can be extended up to 3 mm putting the latch under tension.

This latch is used with strike part numbers 16-7-3739 and 16-7-3742.



Part number	Material	Finish	A	B	C	Weight (g)
16-7-3760	304 stainless steel	raw	55.5	34.5	12	32

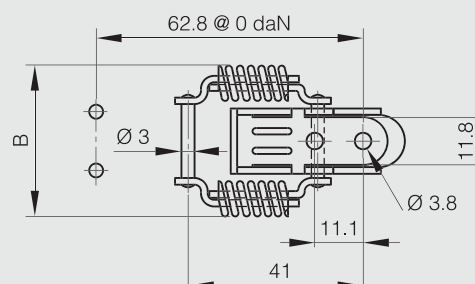
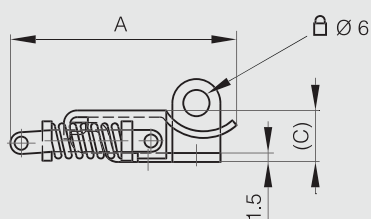

### Strikes for part number 16-7-3760



Part number	Material	Finish	A	B	Note	Weight (g)
16-7-3739	304 stainless steel	raw	28.5	20.5	undrilled	4
16-7-3742	304 stainless steel	raw	28.5	20.5	drilled	4

