



### Counterplates for snap-in magnets

Counterplates for part numbers 16-7-4013, 16-7-4015 and 16-7-3674.

STEEL

Part number	Material	Finish	A	B	C	D	Note	Weight (g)
16-7-3351	steel	zinc plated	41	14	1.5	31	for part number 16-7-4013	6
16-7-3673	steel	zinc plated	66	12	2	54	for part numbers 16-7-3674 and 16-7-4015	11

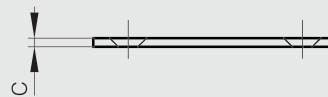
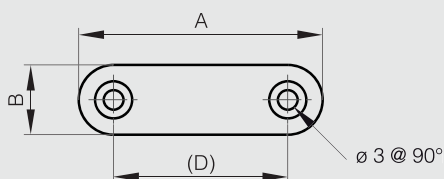

### Housing

Housing for part number 16-7-3674.

For screw-mounting.

POLYMER

Part number	Material	Finish	A	B	C	D	Weight (g)
16-7-3675	polypropylene	black	75.5	14.8	18.5	65	8

