



Toggles latches

Toggle latch without strike - 80.2 mm

The latch is used with strikes part number 16-7-3530.
Latch is available with padlockable option part number 16-7-3724.



Part number	Material	Finish	A	B	C	Note	Weight (g)
16-7-3526	304 stainless steel	raw	80.2	32	14.5	drilled	54

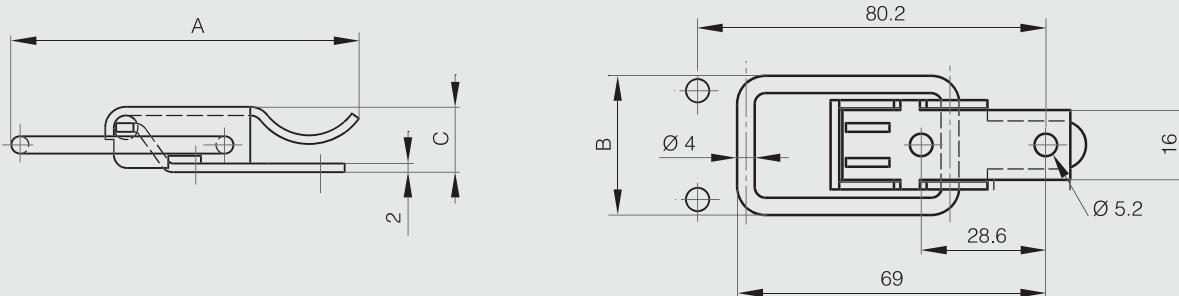

Strike for part number 16-7-3526



Part number	Material	Finish	A	B	C	D	E	Note	Weight (g)
16-7-3530	304 stainless steel	raw	20	26.5	2	15	5.2	drilled	9

