



## Standard toggle latches

### Toggle latches without strike - 80.2 mm

The latches are used with strikes part numbers 16-7-3415 and 16-7-3530.

Latches are available with padlockable option part numbers 16-7-3395, 16-7-3397, 16-7-3723 and 16-7-3724.



Part number	Material	Finish	A	B	C	Note	Weight (g)
16-7-3411	steel	zinc plated	80.2	32	14.5	drilled	54
16-7-3526	304 stainless steel	raw	80.2	32	14.5	drilled	54

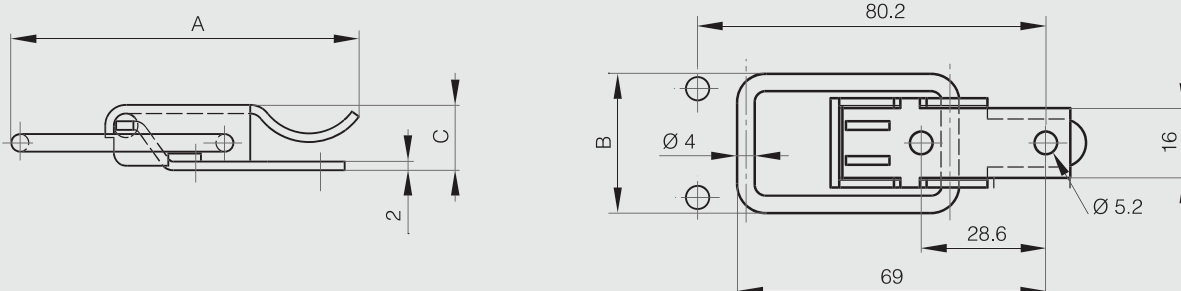

### Strikes for part numbers 16-7-3411 and 16-7-3526



Part number	Material	Finish	A	B	C	D	E	Note	Weight (g)
16-7-3415	steel	zinc plated	20	26.2	2	15	5.1	drilled	9
16-7-3530	304 stainless steel	raw	20	26.5	2	15	5.2	drilled	9

