



Screw-on magnetic catches

Screw-on magnetic catches with counterplate - force 8 kg - high temperature resistance



Part number	Material	Finish	A	B	C	E	F	G	H	Force	Note	Weight (g)
16-7-3391	zinc die-cast	nickel plated	86	16.4	15.6	16	92	76	2	8kg	temperature up to 80°C	112
16-7-3611	zinc die-cast	nickel plated	86	16.4	15.6	16	92	76	2	8kg	temperature up to 300°C	112

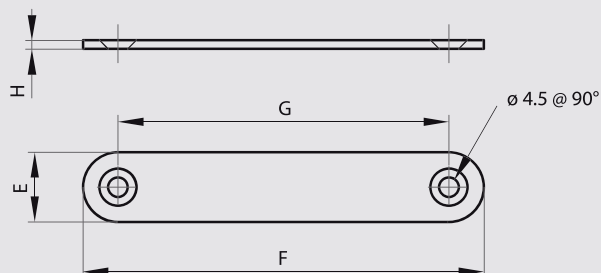
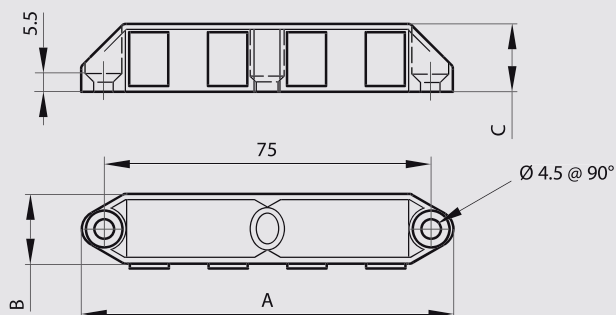

Screw-on magnetic catch without counterplate - force 12 kg



Part number	Material	Finish	A	B	C	D	Force	Weight (g)
16-7-3672	polypropylene	white	74	14	17.5	64	12kg	37

