



Magnetic catches

Flush magnetic catches

Flush magnet with high temperature resistance - force 4 kg



Part number	Material	Finish	A	B	C	D	Force	Note	Weight (g)
16-7-3484	zinc die-cast	nickel plated	56	16.3	16.7	42	4kg	temperature up to 150°C	64

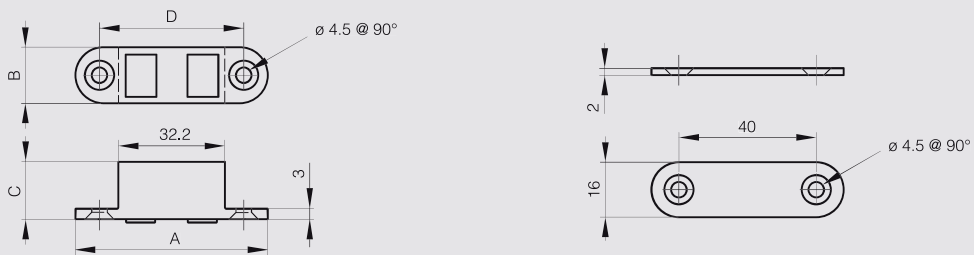

Flush compact magnetic catch without counterplate - force 5 kg



Part number	Material	Finish	A	B	D	Force	Weight (g)
16-7-3387	steel	zinc plated	24	16	13.5	5kg	13

