



Adjustable toggle latches

Adjustable toggle latches with secondary lock and strike

STAINLESS
STEEL STEEL

Part number	Material	Finish	A	B	C	Weight (g)
16-1-9022	steel	zinc plated	70	27.5	13.5	77
16-1-9021	304 stainless steel	electropolished	70	27.5	13.5	77

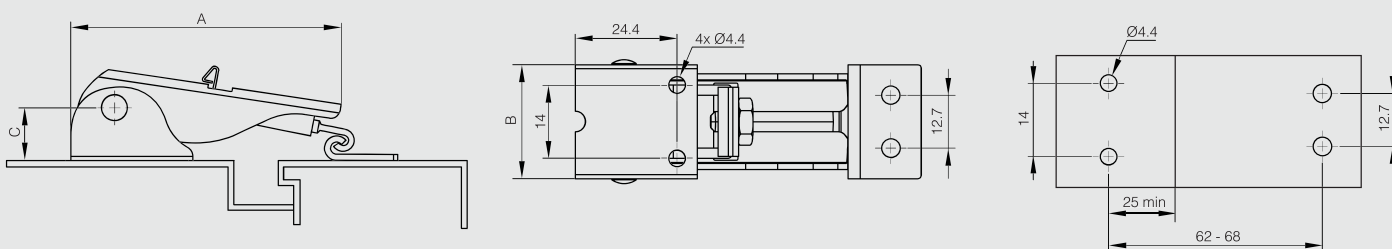

Adjustable toggle latch with strike - 60 mm

Dimension A is adjustable from 60 mm to 65 mm.

STEEL

Part number	Material	Finish	A	B	C	Note	Weight (g)
16-7-3839	steel	zinc plated	60	22	10	60 < A < 65	36

